



設計概念

Design Concept



本次設計項目為老屋翻新，化有形量體結構為無形，是其中的一大挑戰，應對於此，曲線的修飾調整，不只完善空間區隔，更使天花板的高度不致壓縮空間，成為一造型主軸。和屋主討論後，將家屋定調為現代風格，以灰調為主視覺，並運用深色系鋪底，部分加以鮮明色彩點綴，讓各場域顯出自己的節奏與個性。

This is a renovation project of a vintage house. In view to challenge the open configuration, we transformed the base structure, moreover, modify the flow, and hence bring about excellent layout. The tray ceiling becomes a striking feature of the space. After discussion with the property owner, we set the contemporary style of the foundation, with the grey hue as the accent color, and make use of deep tinge as the secondary color, further, put a touch of bright color, as well helping each field to stand out the exclusive texture and personality.

藍釉流淌

Flashing Aqua





藍釉流淌 *Flashing Aqua*

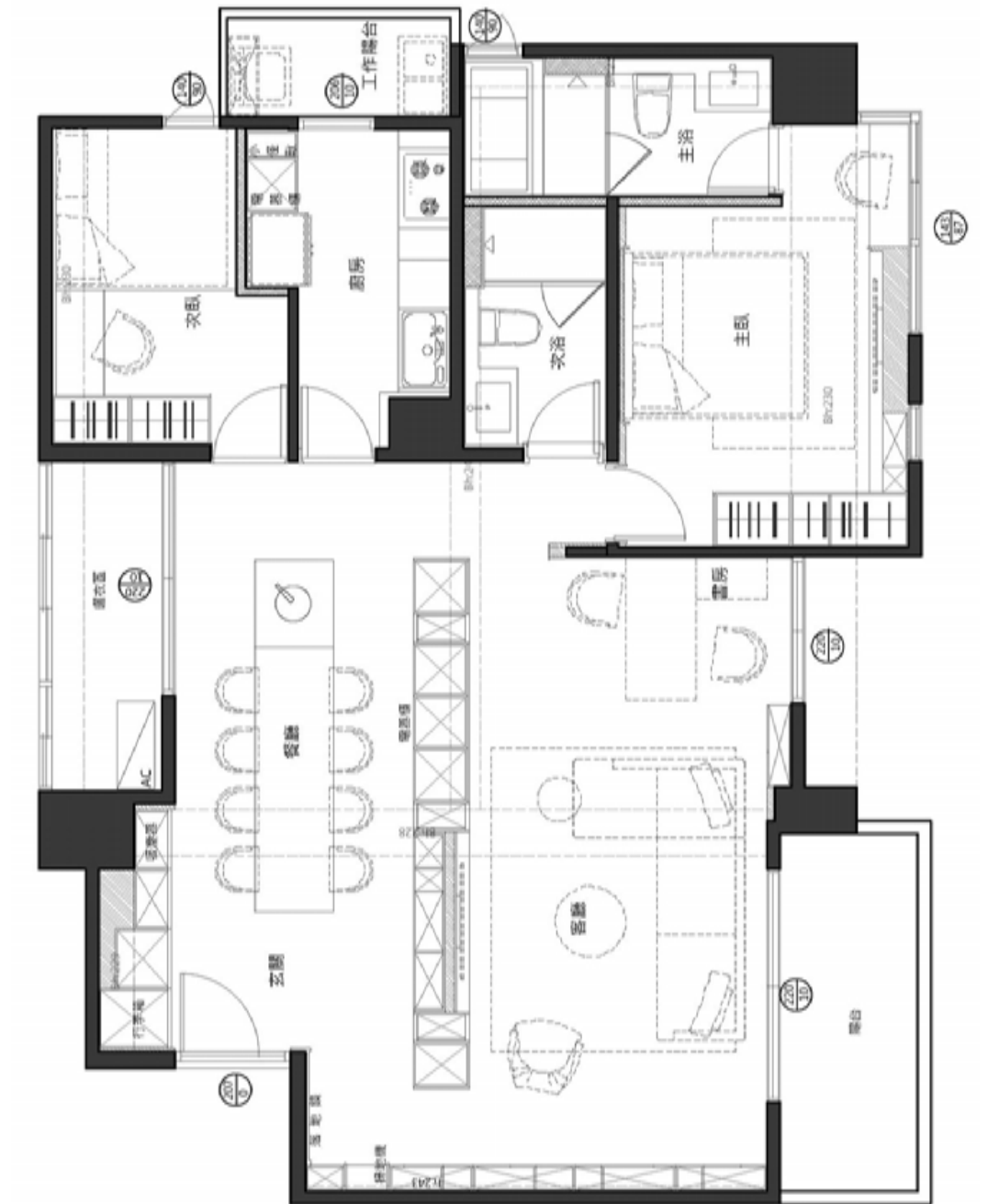

明確分界放大視域

Clear division expand visual perception



室內公領域原先劃設為三區，動線不甚流暢，拉出軸線後，轉換沙發位置使其與餐桌平行，不僅拉大空間，也明確劃分客餐區界線，同時使光線的滲透更加透澈。

The public area was originally divided into three zones, and the flow was not very smooth. After setting the axis, we set the position of the sofa to make it parallel to the dining table, which not only create a spacious site, but also clearly separate the dining and living area, and at the same time bring out a penetrate and transparent space.

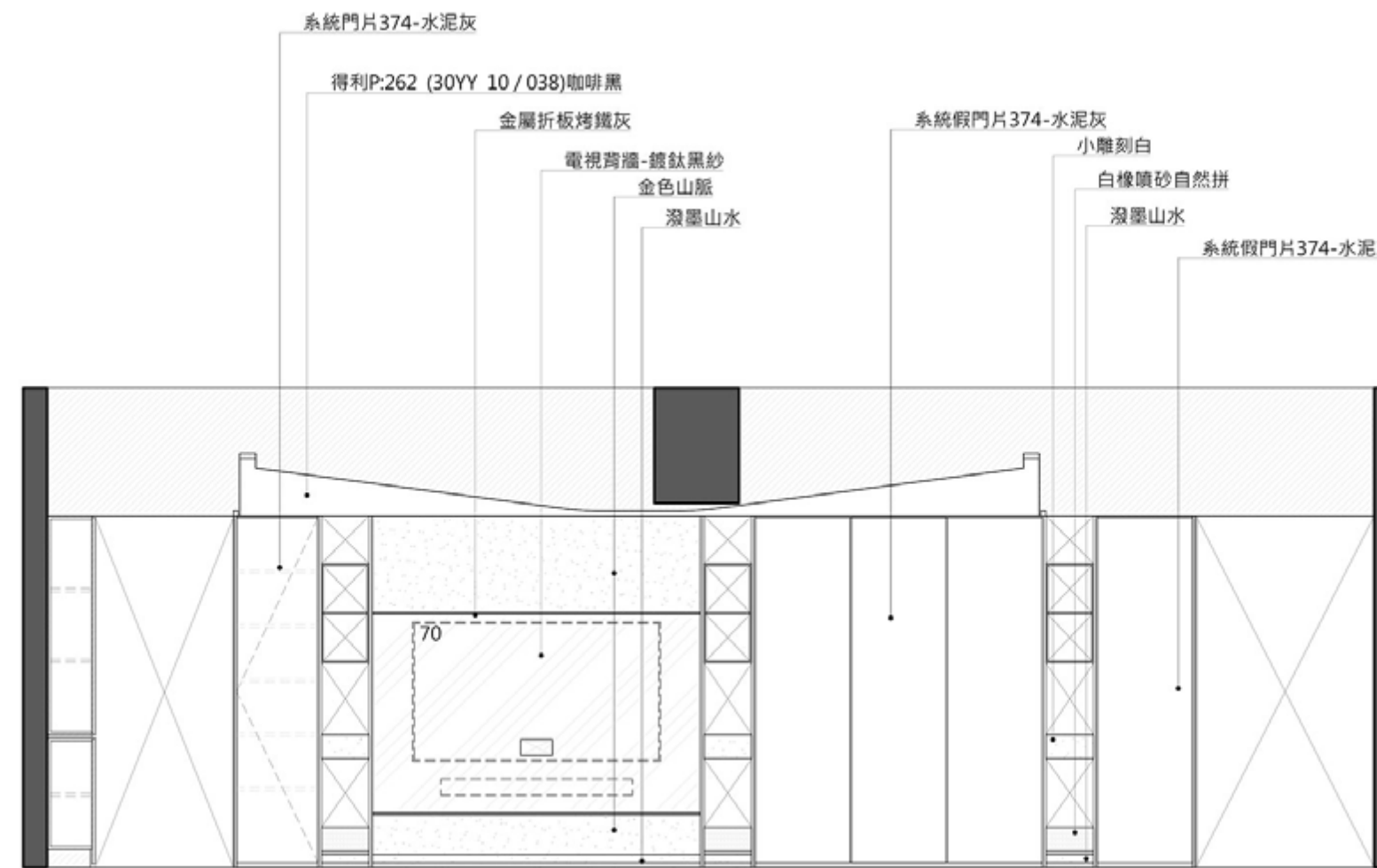

電視牆

TV wall

區隔兩處的電視牆特意採開放式做法，在電視兩側設立展示櫃體，通透的設計手法考量了採光需求，木頭立櫃雖擺放飾物，仍以貫穿型的櫃面使人能看見餐區場景，形塑視覺上的新奇感受。

The TV wall plays the role of the partition of the two areas, which set up wooden display shelves on both sides. And take the advantages of the penetrating design that besides displaying art ornaments, further, meet the lighting demand. The shelves make people could see the dining area and then form an inviting feeling visually.



藍釉流淌

Flashing Aqua

忠實呈現料材質地

Truly present the texture of materials

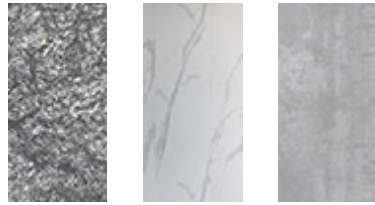

石材與實木木皮為主要用料，兩者相乘顯露溫潤質感，為兼顧現代風，因此加入鍍鈦材質，使空間調性一致。除此之外，使用仿水泥紋路、大理石紋等系統板材替代實質物體，以單純元件相互搭配豐富場域，且保留用料原始質感以呈現物件真實質地。

身為客廳主角的電視櫃，由結晶石金色山脈與做成皮革面的潑墨山水石材相偕；前者透過光的倒影，產生動態閃爍感，後者在捨棄亮面作法後，彷彿山水畫，且現出真實繪畫質感。電視兩側櫃體使用仿水紋路系統板材，斑駁色紋流竄，使牆體不致素面而單調。

We make use of stone and solid wood veneer as for the main materials that both reveal gentle texture. Moreover, adopt the titanium processing to present the contemporary style, and bring about the harmonious tone of the space. And then, we select system plywood of imitation cement pattern and marble finish to replace the genuine materials. The plain elements that retain the innate texture of the materials accordingly create an original charm of the whole space.

The TV wall is the focal point of the living area, it is constructed of crystal marble and assort with a stone of ink landscape touch. The marble shows the dynamic flickering perception via the reflection of light; and the stone does away the polish processing, hence brings out the ink painting texture. The built-in cabinets by sides make use of system plywood, yet the water flow finish surface shows the vivid image of the wall.



藍釉流淌 Flashing Aqua

鏡射效果延展視感

Mirroring effect extends the visual perception

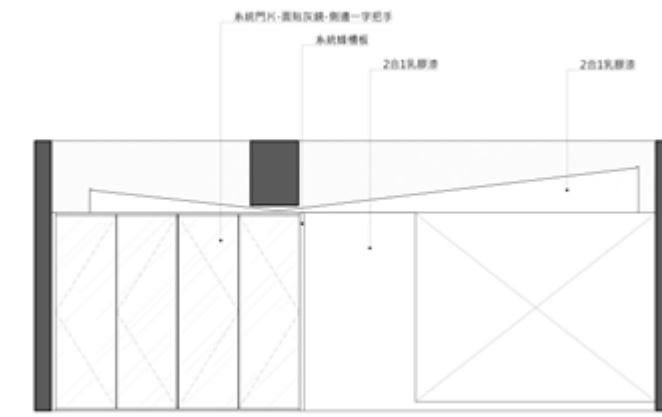

由客廳通往餐區的廊道處設置明鏡，拉長視線引導，加深空間的延續效果。餐區部分亦在一側的下方裝設灰鏡收納櫃，比起明鏡的清晰照映，顯得較為沉著冷靜，成為歸宅的緩衝區，使人一進屋便頓感安穩；而灰鏡的上方分別為鍍鈦抽屜與黑色層架，一方面摻入現代風元素，一方面接續空間的灰白調性。

Set a bright mirror of the corridor from the living room to the dining area, which elongates the sight and create the capacious effect. The bottom of the stow cabinets in the dining area is equipped with grey mirrors of calm factor, and the upper part of the grey mirror is the titanium-plated drawers and black shelves that integrate the modern element and neutral tone of the space.

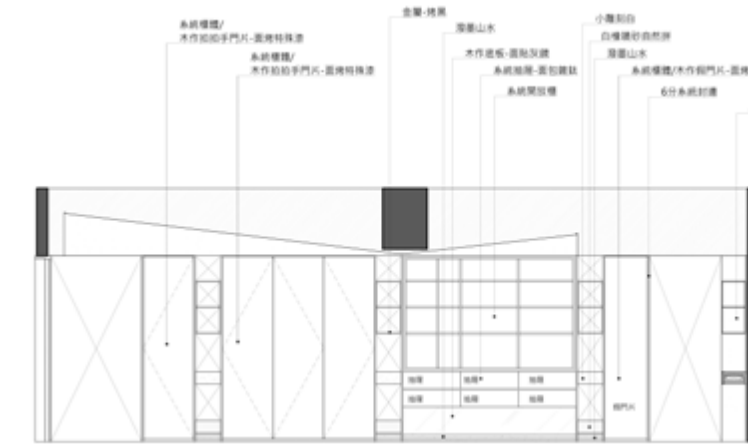
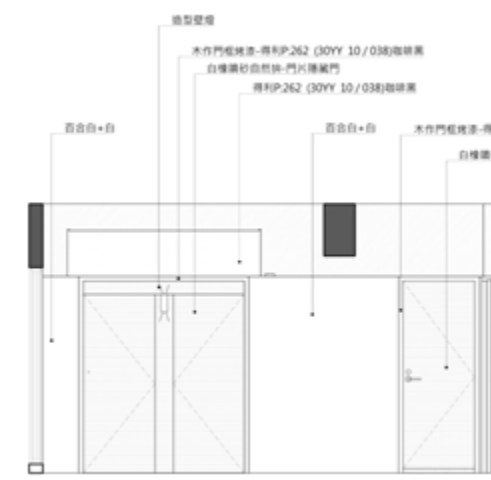

餐桌內層使用亮藍色，而次臥室也以相類色調作為敘事主軸，貫穿顏色的相異筆法於各場域，使各區塊皆具備獨有韻律，不受單一的灰黑色系消弭特質，各具風貌形色相得。

Paint the inner side of the dining table legs of bright blue, and adopt the similar color scheme for the second bedroom. By way of the corresponding hue to let each area shows the unique feature, and set off the exclusive character of different space.



藍釉流淌

Flashing Aqua



形隨機能消弭框架

Functional designs bring about the unimpeded layout



流理臺後隱藏通往次臥與廚房的兩扇門，化除雙門扉相塞於同一畫面的突兀感，將原本過度張揚的門縫化為造型牆，化而為獨一牆體。

In view to eliminate the odd vision of the adjacent doors at the rear of the kitchen counter, which leads to the second bedroom and the kitchen, therefore we decorate with a feature wall.

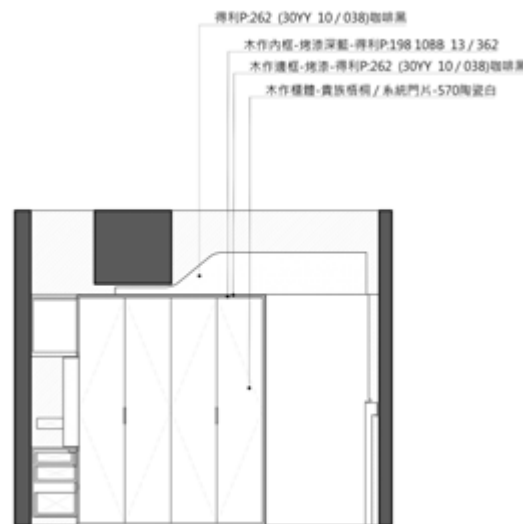
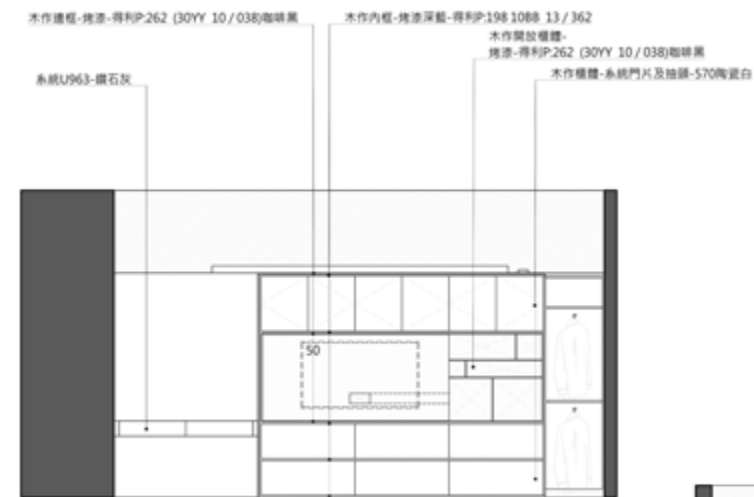
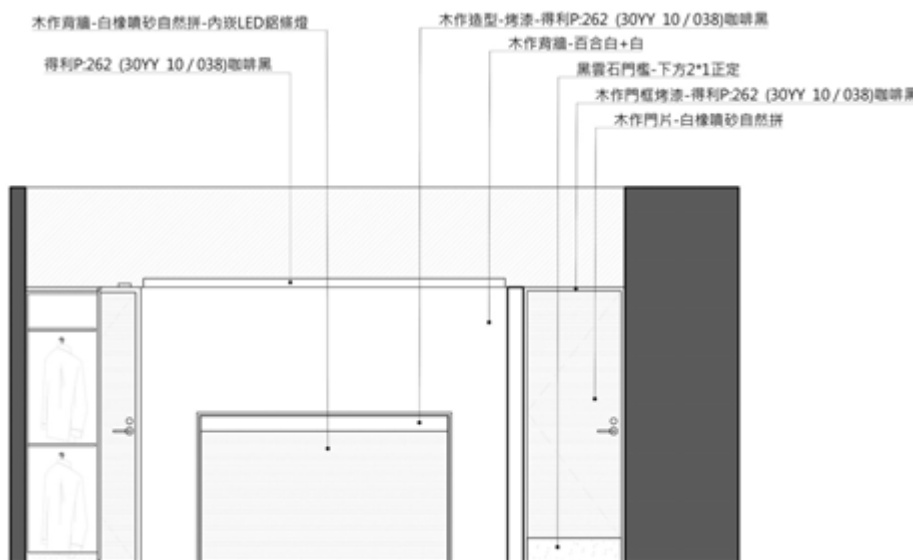

主臥則是全案對於收納所設計的一大展現，當中的L型電視收納牆原為窗面，由於光線過多不適於休憩，故為遮蔽考量，結合收納與適宜睡眠的兩樣因素，轉換其為衣櫥延伸的展示及收納區。

The function storage of the master bedroom is the eye catch design of this project. The L-shape cabinets merge the function of TV Set, where are the windows of the original pattern. Considering of excessive light situation, which is not suitable for rest, hence block out the windows and transformed into a built-in wardrobe that unites the two factors of stow and relaxation.

形 隨 機 能 消 弭 框 架

Functional designs bring about the unimpeded layout

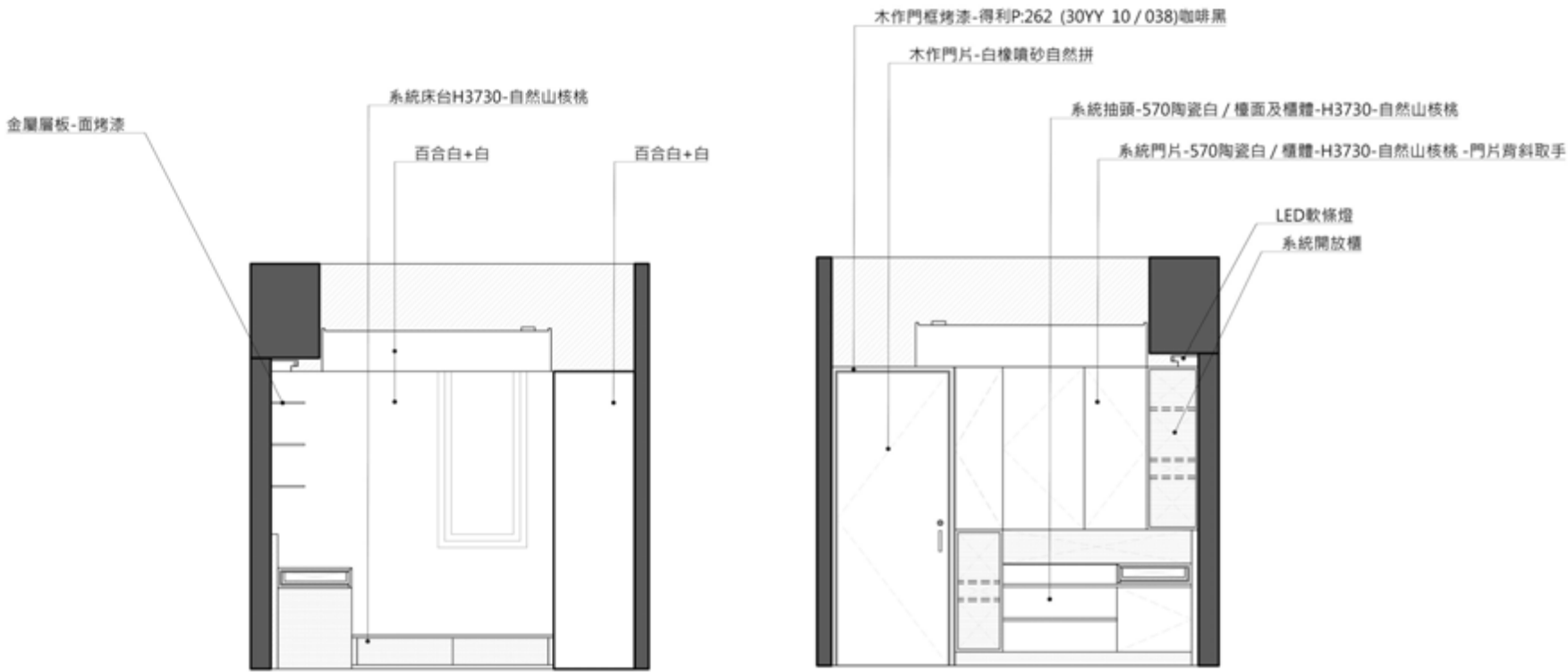
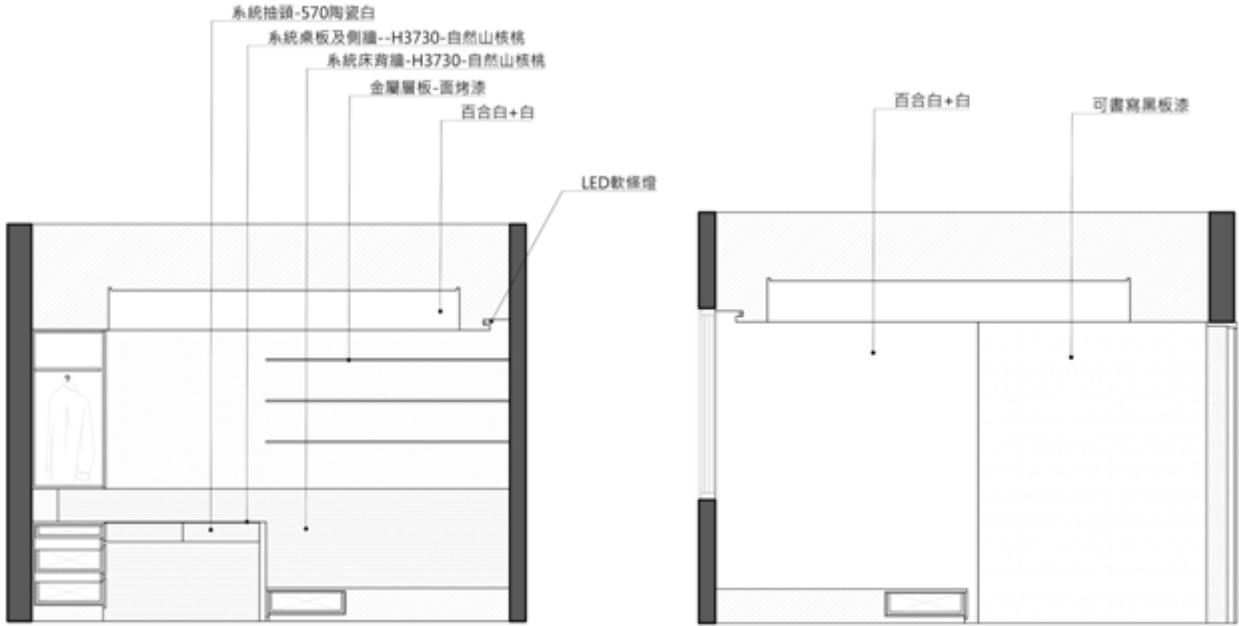

對比光線過度而需遮擋的主臥，次臥則有光源不足的情形，因應採光不佳的限制，免去純灰及黑白配置，改採大面積白色與淺藍色，加強空間的溫潤感，以色系補足空間缺乏的亮度。面對量體的限制，我們以巧妙的修飾直面化解，雖然討論出特有風格，卻不被其框架，在此次舊屋改造的執行中，仍營造出調性趨同且個性鮮明的家屋印象。

Relative to the too much light issue of the master bedroom, the second bedroom has the situation of insufficient light. Due to the limitation of poor lighting, we abandon the low Chroma configuration of grey and black, and alter to make use of white and light blue, hopes to manifest the warmth perception of the space, and further, to supplement the lack of brightness of the space. Though there are some restrictions about the building structure, we ingeniously solve the problems by way of the modified finishing. In the processing of the renovation, we go all in to bring about the harmonious tone and the exclusive stylish impression of home.

藍釉流淌
Flashing Aqua



Thank You

藍釉流淌

Flashing Aqua