



Interasia

Taipei



INTERASIA VISION

Concept

以貨輪作為空間雛型的發展概念，抽象的表現出船體 / 艦橋的空間形式，另外使用企業LOGO類似於七巧板的概念，塑造出符合該企業CI的視覺效果

Drawing inspiration from the concept of a cargo ship, we've developed the spatial layout to abstractly represent the form of the ship's hull/bridge. Additionally, incorporating the company logo in a manner akin to a puzzle piece, we've crafted a visual aesthetic that aligns with the company's corporate identity.

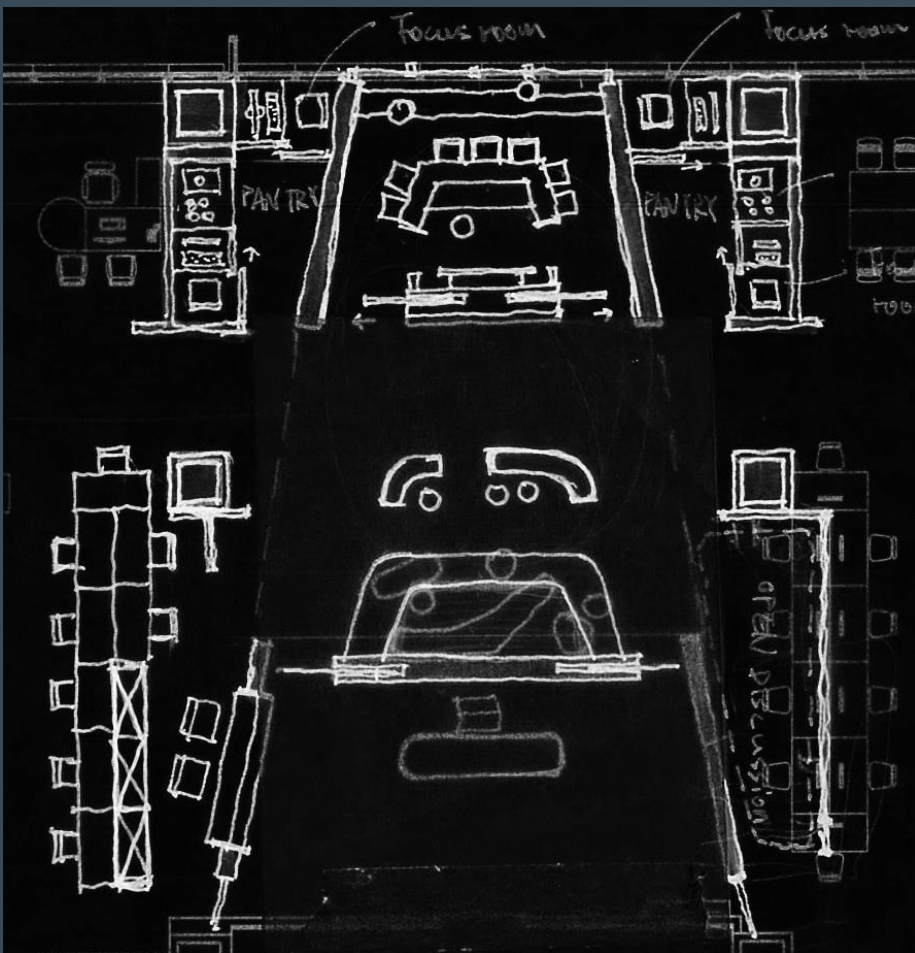

Corporate Identity

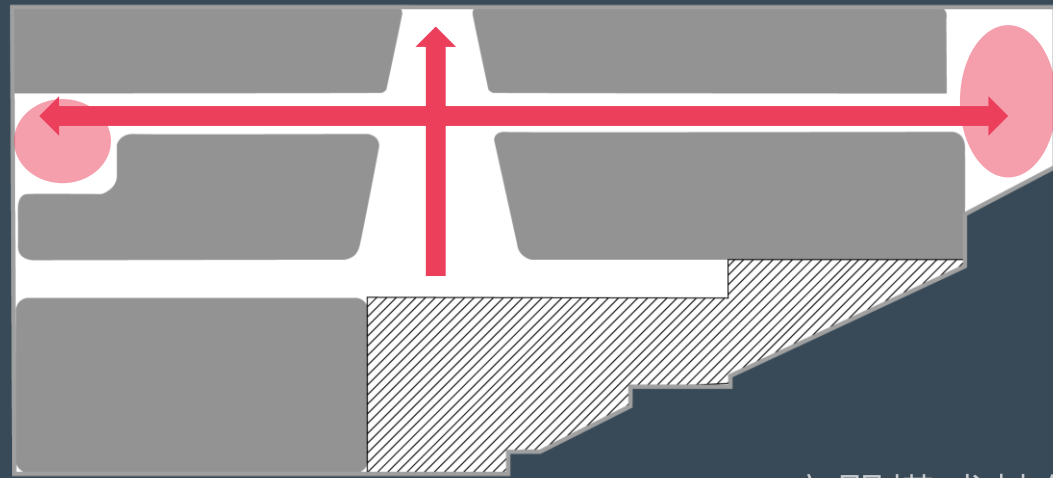

◆空間構成軸線

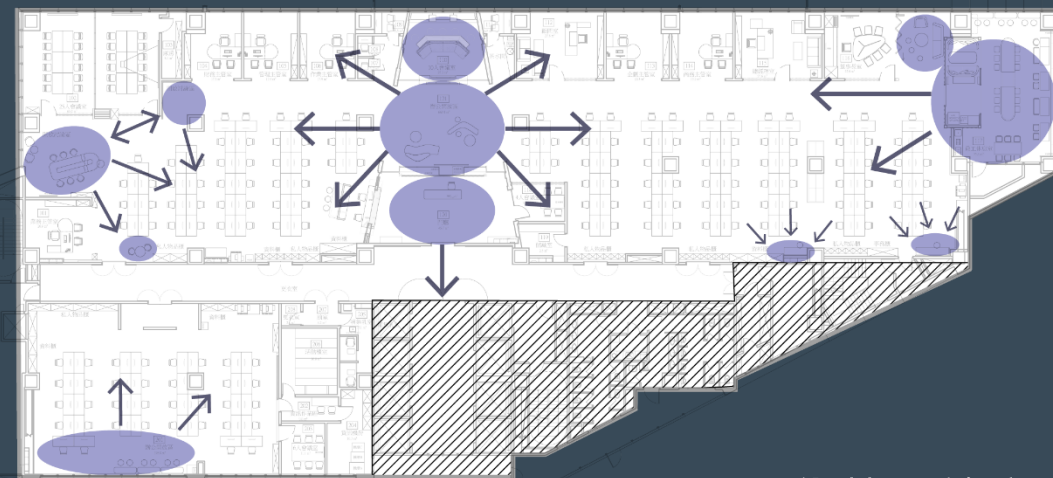

◆公共開放空間

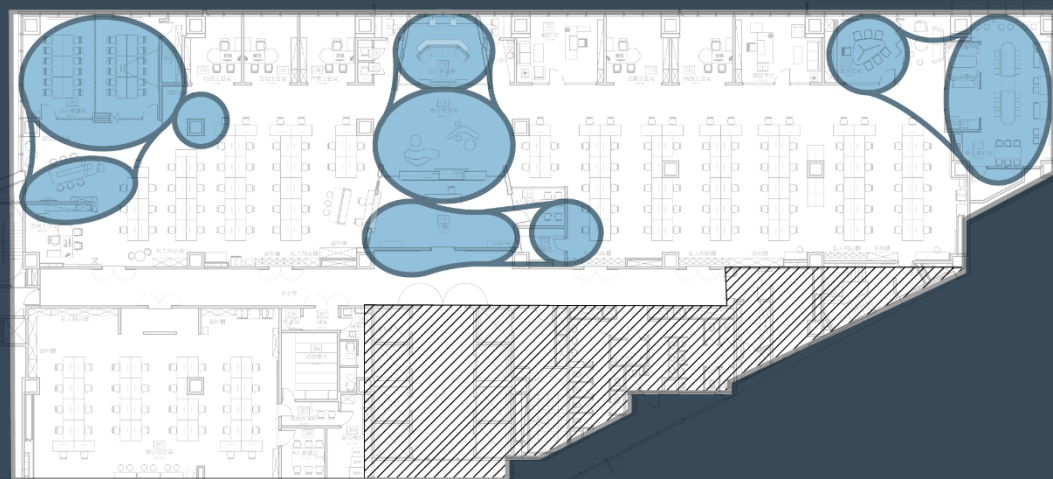

◆開放空間整合

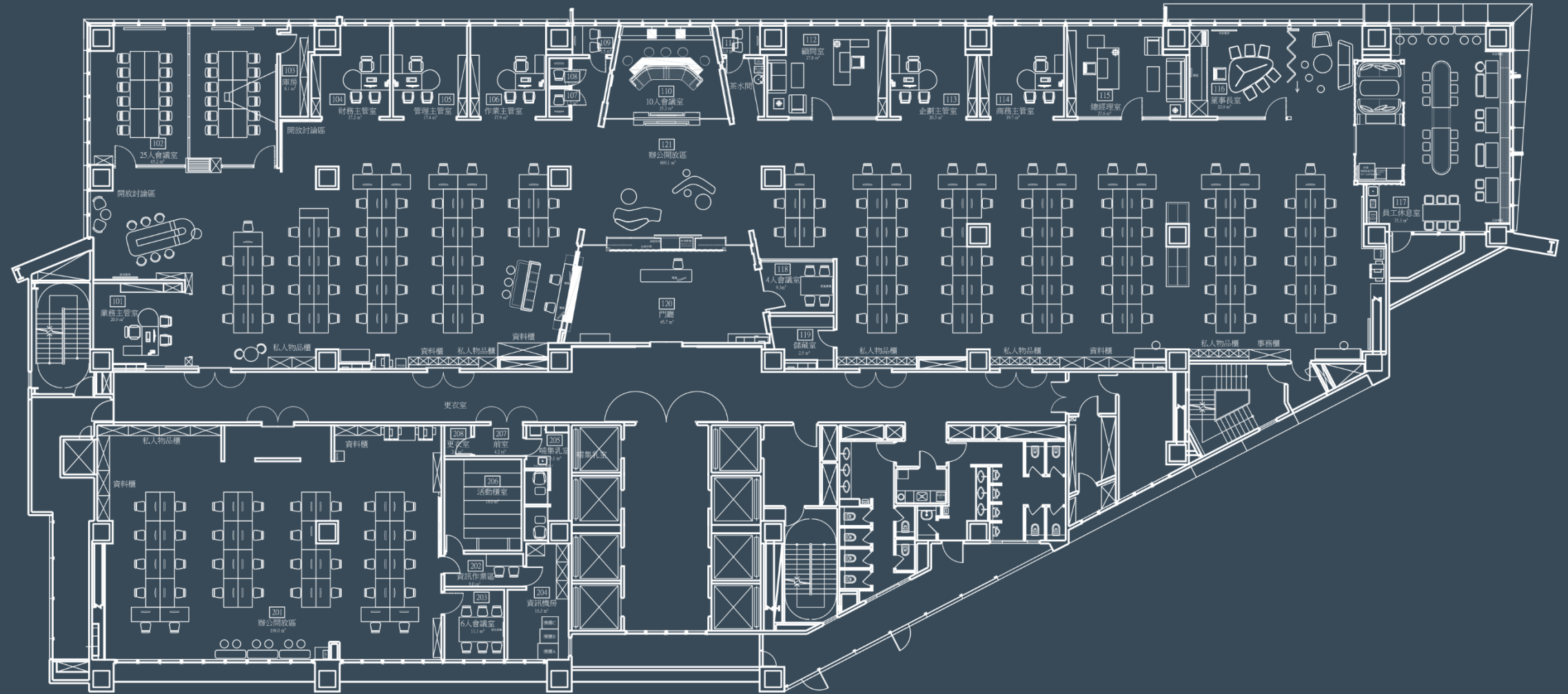

平面的空間架構，主體是以中央進入，中央為企業CI主題的軸線(短軸/形象軸線)，左右沿伸為動線發展的軸線(空間序列/左右端點軸線)。空間中開放 / 多用途的區域也多分布在中軸區和左右二側的端點。

The spatial layout is predominantly planar, with the central entrance serving as the main axis aligned with the corporate CI theme (short axis/image axis). Extending from the central axis are the axes for the development of circulation (spatial sequence/left and right endpoint axes). Open/multi-functional areas within the space are also distributed predominantly along the central axis and at the endpoints on both sides.

Concept – Spatial Composition

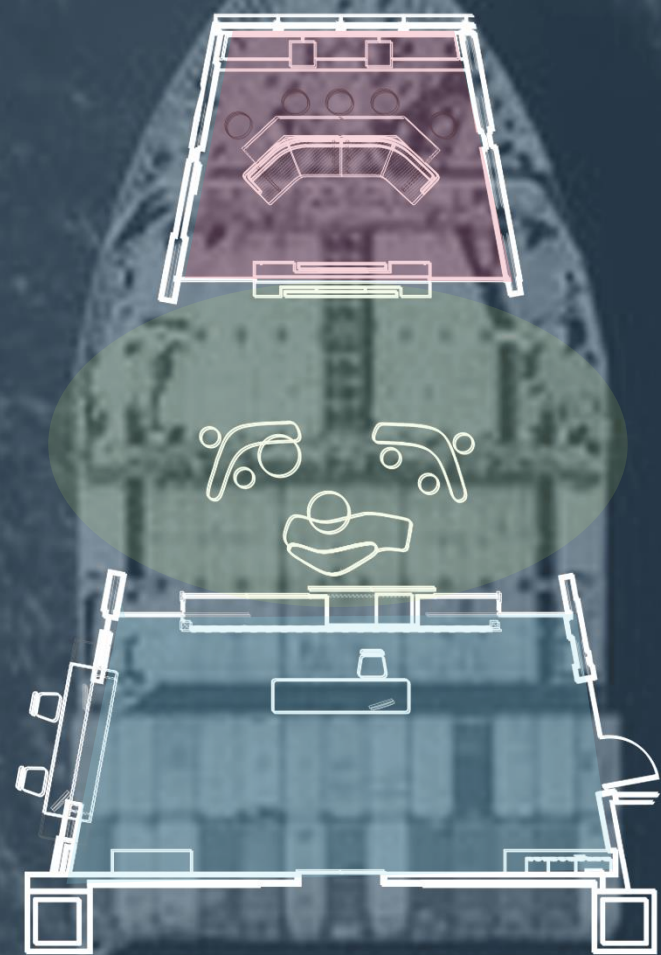

◆企業戰略討論 — 艦橋

◆休息 / 會談 — 活動甲板

◆接待 / 中控 — 控制室

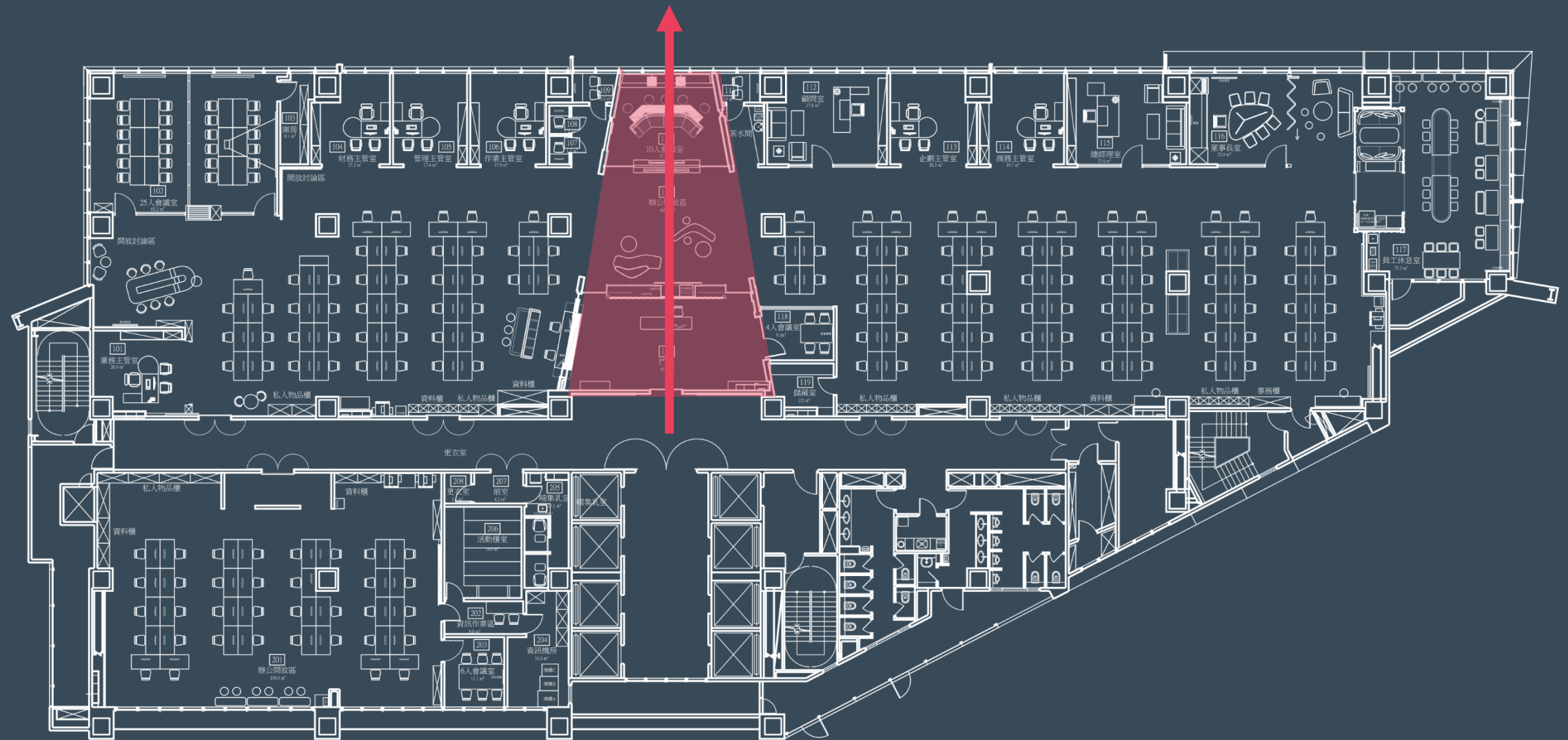

Y向軸線的空間架構，以中央入口進入**第一進**接待區，在空間架構和機能上類比於船艙的控制室，為人員與設備的中央控制區。**第二進**類比為開放活動甲板，機能上供同仁活動休憩和動線，**第三進**為類比船隻的決策中心也就是艦橋，機能上為創意與決策的討論空間。

The spatial structure along the Y-axis begins with the central entrance leading to **the first section**, the reception area, which is conceptually akin to the control room of a ship, serving as the central control zone for personnel and equipment. **The second section** is analogous to an open activity deck, providing space for colleagues to gather, relax, and move around. **The third section**, akin to the decision-making center or bridge of a ship, functions as a space for creative brainstorming and decision-making discussions

Concept — Spatial Device

以LOGO角度斜線為概念，構成具有光澤表面的大片主題牆面，另一側設置大型影像(具有發光性)

Utilizing the diagonal angle of the corporate logo as a concept, we've created a large thematic wall with glossy surfaces. On the other side, a large-scale display screen is installed (with luminous properties).

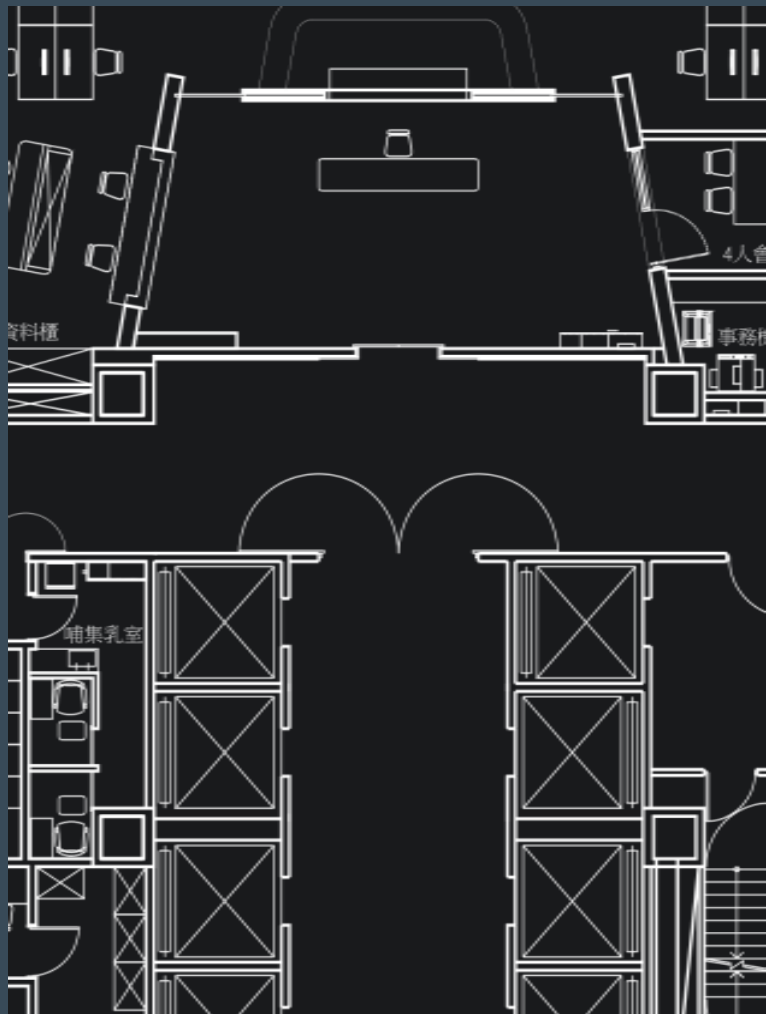

Entry



Counter / Casher

接待櫃檯，兼具作業座位和收納櫃的機能。船單出納櫃台為90公分高的櫃台形體。二個櫃台同樣以木紋與白色顆粒紋理人造石構成為基材，加上燈光及浮雕/廣告切割物造型

The reception counter serves as both a reception desk and a storage cabinet. The cashier counter is a 90-centimeter-high counter form. Both counters feature wood grain and white artificial stone, enhanced with lighting and cutout advertising designs.

位於大廳的會議/會客空間，提供訪客會面或討論使用

The meeting/guest space located in the lobby provides an area for visitor meetings or discussions.

Conference





開放空間設置**企業形象螢幕**，可播出企業形象影片或相片輪播，並在特定時間或活動時，可做為影像主題牆。

In the open social space, there is a corporate image display screen set up, capable of playing corporate image videos. It can also serve as a thematic video wall during specific times or events.

Information Wall / Event area



座位的型式有沙發 / 高腳椅 / 沿窗長凳，為多樣性討論的空間

The seating options include sofas, high stools, and along-window benches, providing a diverse space for discussions.

Conference

延伸自門廳 / 開放空間的形象牆面進入**多功能會議室**，構成為一體三進的軸線空間，當拉門開啟時，可以與門廳和開放空間連為一氣

The image wall extending from the foyer/open space into the multipurpose conference room forms a unified three-part spatial axis. When the sliding door is opened, it seamlessly connects with the foyer and open space.



高階主管辦公室 / 部門主管辦公區的正面長向立面，使用木紋質感、灰色調烤漆框玻璃，視線高度設置與船舶相關工程圖圖像的霧面玻璃貼，做視線遮擋。

The facade of the executive offices/departmental management areas features a wood grain texture, grey-tone frames with glass. Frosted glass panels depicting engineering diagrams related to ships are positioned at eye level to provide visual privacy.



Partition wall

大會議區外設有休息/討論的前區，提供同仁討論 / 與會外賓休息或會議間的討論需求。討論牆面旁轉角設有開放圖書櫃供同仁使用

Adjacent to the main conference area is a front area designated for relaxation and discussions, catering to both colleagues' discussion needs and providing a space for external guests to relax or engage in meeting discussions. Additionally, there's an open bookshelf situated at the corner next to the discussion wall for colleagues to utilize.



Open Discussion / Library

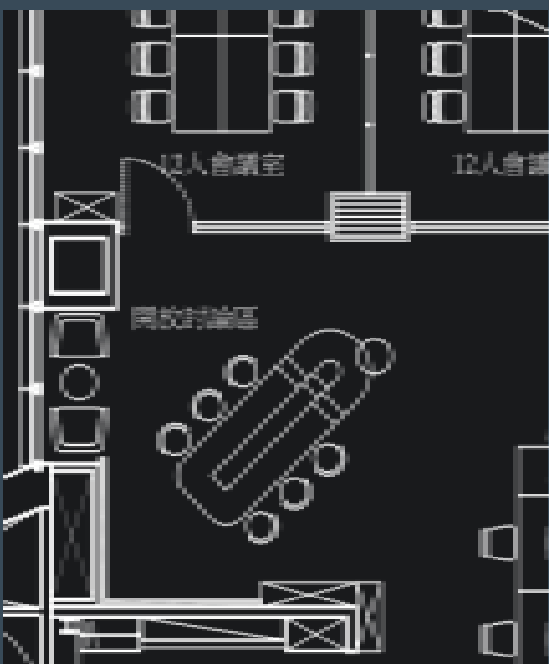



3D Simulation &
Completion **Photo**

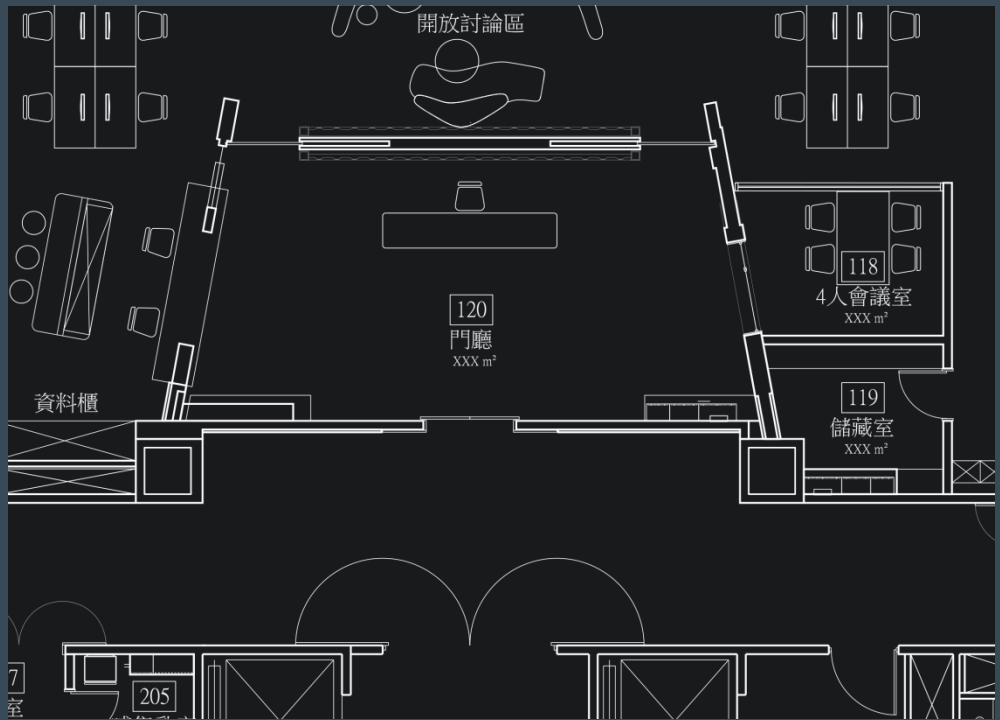

以LOGO角度斜線為概念，構成具有光澤表面的大片主題牆面，另一側設置大型影像(具有發光性)

Conceptualized with the diagonal angle of the CI logo, we've designed a large thematic wall with glossy surfaces. On the other side, a large-scale lighting box screen is installed (with luminous properties).

Corporate image wall

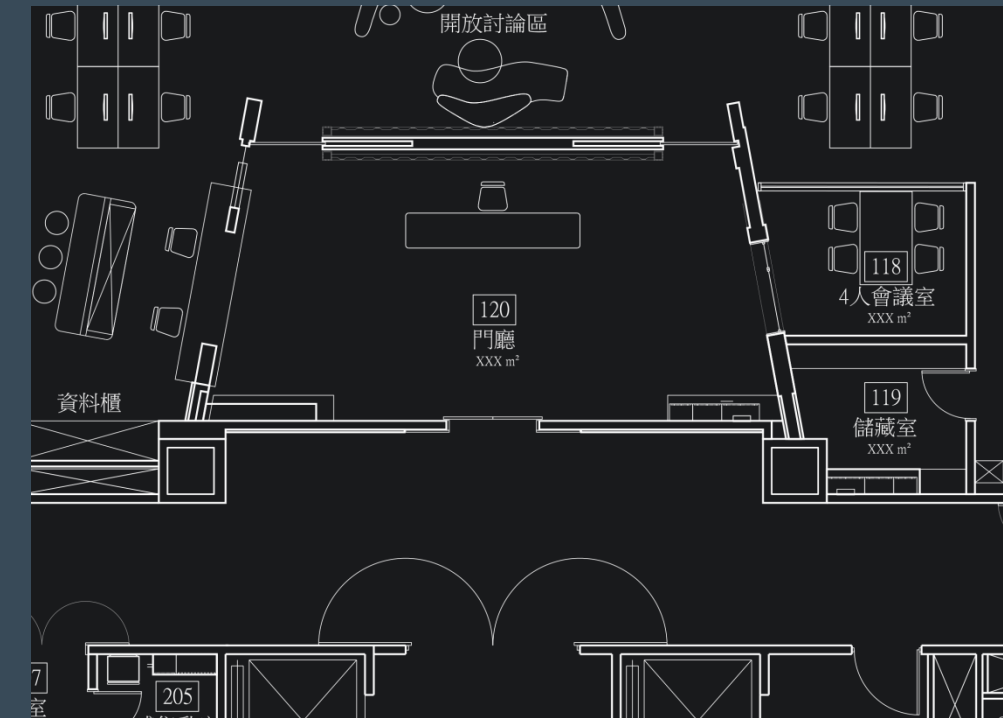

以LOGO角度斜線為概念，構成具有光澤表面的大片主題牆面，另一側設置大型影像(具有發光性)

Conceptualized with the diagonal angle of the CI logo, we've designed a large thematic wall with glossy surfaces. On the other side, a large-scale lighting box screen is installed (with luminous properties).

Corporate image wall



Counter / Cashier

接待櫃檯，兼具作業座位和收納櫃的機能。船單出納櫃台為90公分高的櫃台形體。二個櫃台同樣以木紋與白色顆粒紋理人造石構成為基材，加上燈光及浮雕/廣告切割物造型
The reception counter and cashier counter are both made of wood grain and white granular textured artificial stone, enhanced with lighting and advertising designs.

位於大廳的**會議/會客空間**，提供訪客會面或討論使用
The meeting/guest space located in the lobby provides an area for visitor meetings or discussions.

Meeting Room





Counter / Cashier

接待櫃檯，兼具作業座位和收納櫃的機能。船單出納櫃台為90公分高的櫃台形體。二個櫃台同樣以木紋與白色顆粒紋理人造石構成為基材，加上燈光及浮雕/廣告切割物造型
The reception counter and cashier counter are both made of wood grain and white granular textured artificial stone, enhanced with lighting and advertising designs.

位於大廳的**會議/會客空間**，提供訪客會面或討論使用
The meeting/guest space located in the lobby provides an area for visitor meetings or discussions.

Meeting Room





Information Wall / Open discussion area



開放空間設置**企業形象螢幕**，可播出企業形象影片或相片輪播，並在特定時間或活動時，可做為影像主題牆。

There is a video display wall set up for playing corporate videos, which can play company introduction videos at fixed times.



開放空間設置**企業形象螢幕**，可播出企業形象影片或相片輪播，並在特定時間或活動時，可做為影像主題牆。

There is a video display wall set up for playing corporate videos, which can play company introduction videos at fixed times.



Information Wall / Open discussion area



座位的型式有沙發 / 高腳椅 / 沿窗長凳，為多樣性討論的空間

The seating options include sofas, high stools, and benches, creating a diverse space for discussions.

Conference Room

延伸自門廳 / 開放空間的形象牆面進入**多功能會議室**，構成為一體三進的軸線空間，當拉門開啟時，可以與門廳和開放空間連為一氣。

Extending from the foyer/open space into the multipurpose conference room, it forms a continuous three-part axial space. When the sliding door is opened, it seamlessly integrates with the foyer and open space.





座位的型式有沙發 / 高腳椅 / 沿窗長凳，為多樣性討論的空間

The seating options include sofas, high stools, and benches, creating a diverse space for discussions.

Conference Room

延伸自門廳 / 開放空間的形象牆面進入**多功能會議室**，構成為一體三進的軸線空間，當拉門開啟時，可以與門廳和開放空間連為一氣。

Extending from the foyer/open space into the multipurpose conference room, it forms a continuous three-part axial space. When the sliding door is opened, it seamlessly integrates with the foyer and open space.

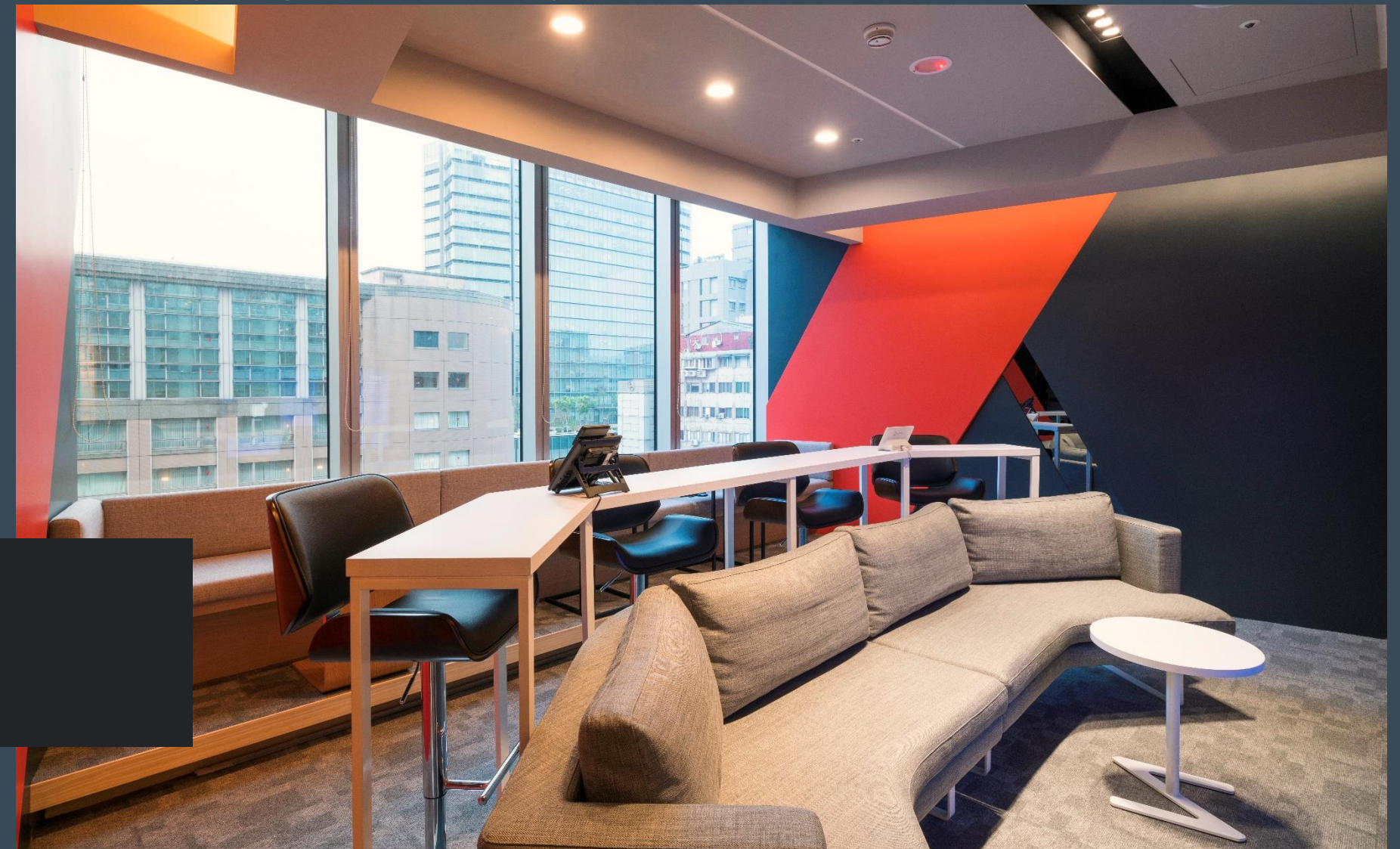



本案設計配色跟循業主企業的主題色調，並且因為主體為航運公司，在開放區域以貨櫃牆體作為空間元素。
The color scheme of this design incorporates the tones of the corporate identity, with cargo containers used as spatial elements in the open area.

3D Perspectives





本案設計配色跟循業主企業的主題色調，並且因為主體為航運公司，在開放區域以貨櫃牆體作為空間元素。
The color scheme of this design incorporates the tones of the corporate identity, with cargo containers used as spatial elements in the open area.

3D Perspectives



彈性討論會議使用的**董事長室**，可以調整玻璃隔屏與外側的開放討論區合而為一開放討論區。董事長的私人物品可整合收納於私人櫃中

The space of the chairman's office can open up the glass partition to combine with the adjacent open discussion area, creating a larger open discussion space. The chairman's personal belongings can be neatly stored in integrated storage cabinets.

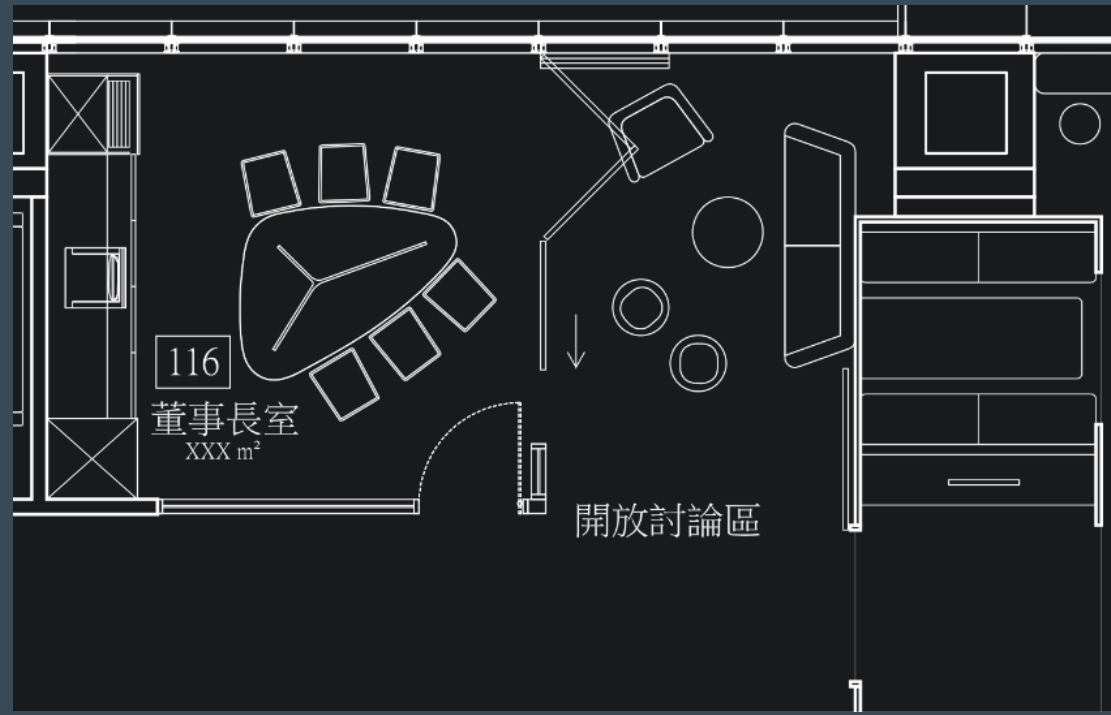

Chairman's room

彈性討論會議使用的**董事長室**，可以調整玻璃隔屏與外側的開放討論區合而為一開放討論區。董事長的私人物品可整合收納於私人櫃中

The space of the chairman's office can open up the glass partition to combine with the adjacent open discussion area, creating a larger open discussion space. The chairman's personal belongings can be neatly stored in integrated storage cabinets.

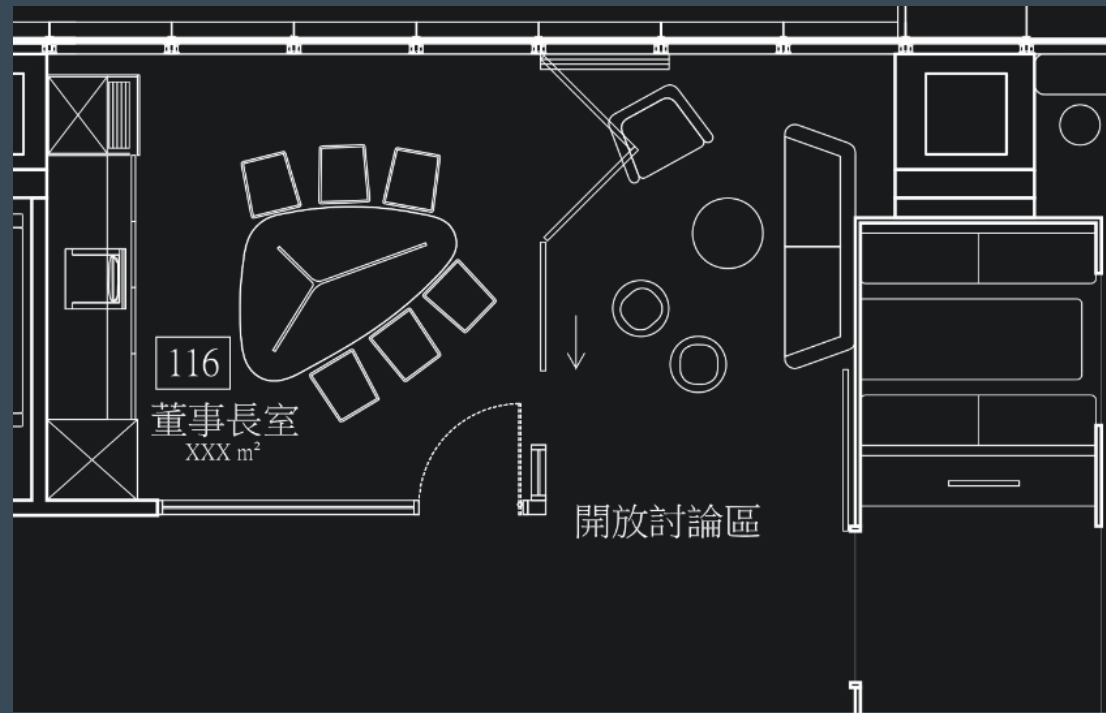

Chairman's room



介於休息室與董事長辦公室之間的**開放討論空間**，能與開放後的董事長室連為一起，成為一個整體活動空間。
The space of the chairman's office can open up the glass partition to combine with the adjacent open discussion area, creating a larger open discussion space. The chairman's personal belongings can be neatly stored in integrated storage cabinets.

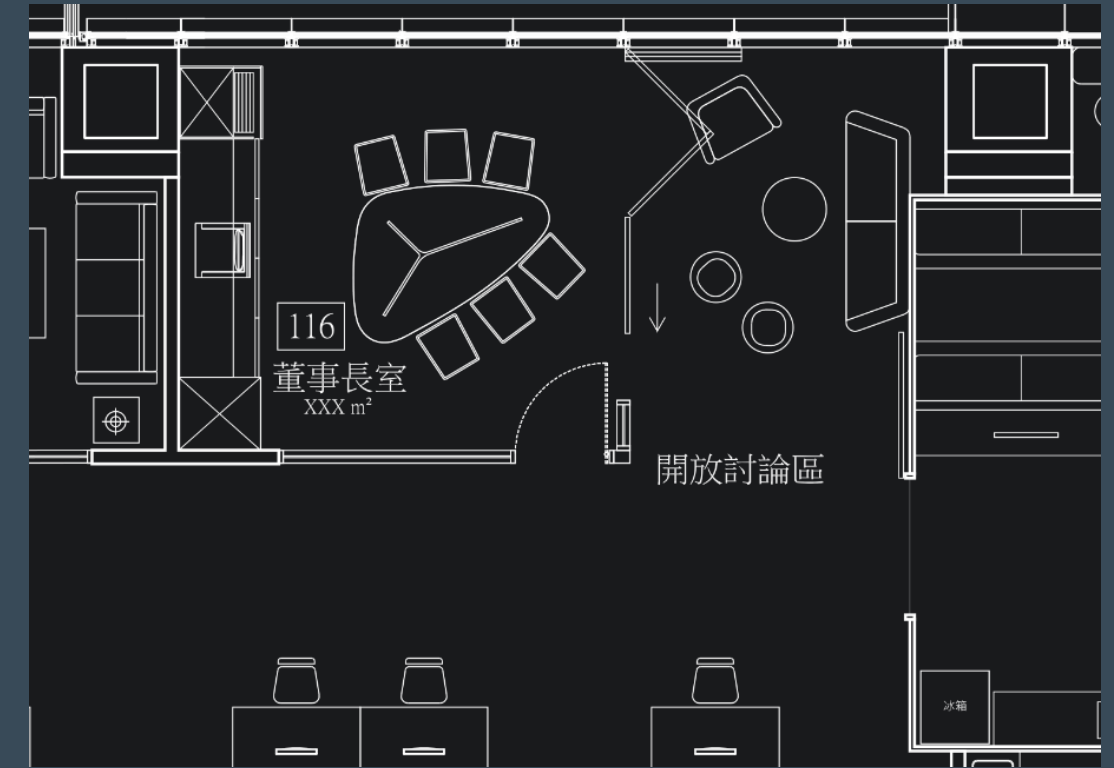

Open Discussion

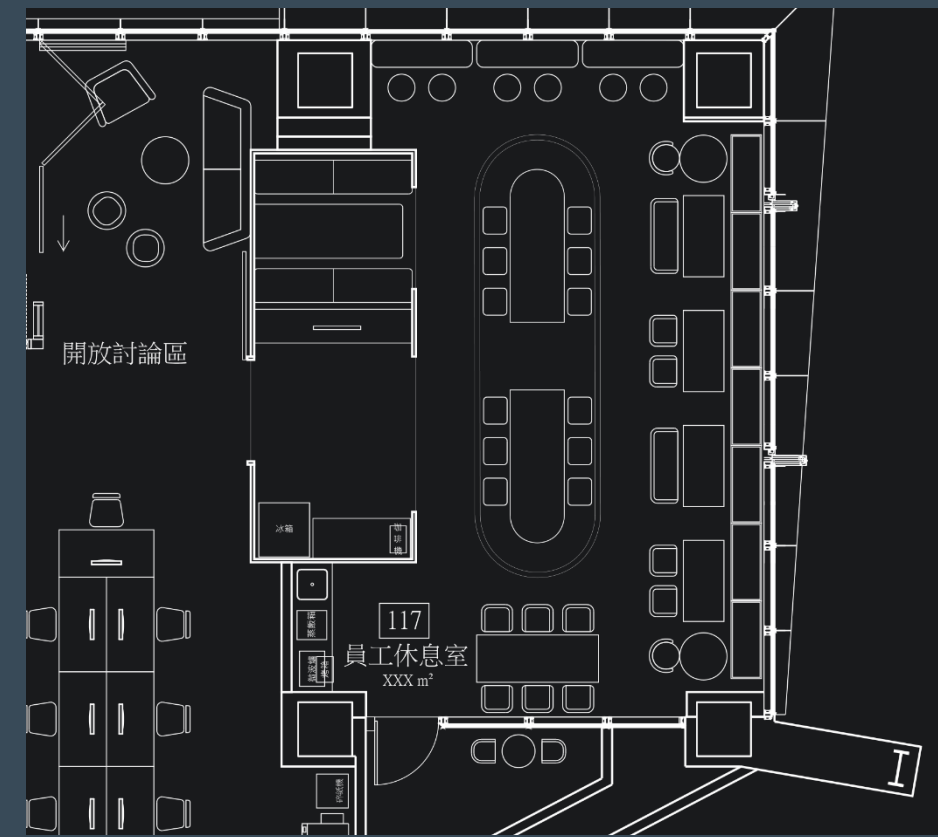

以貨櫃作辦公區與休憩空間的**中介過渡**，再將一些機能整合在其中

The cargo containers as an intermediary transition between office areas and Break room, with some functionalities integrated within.



Break Room

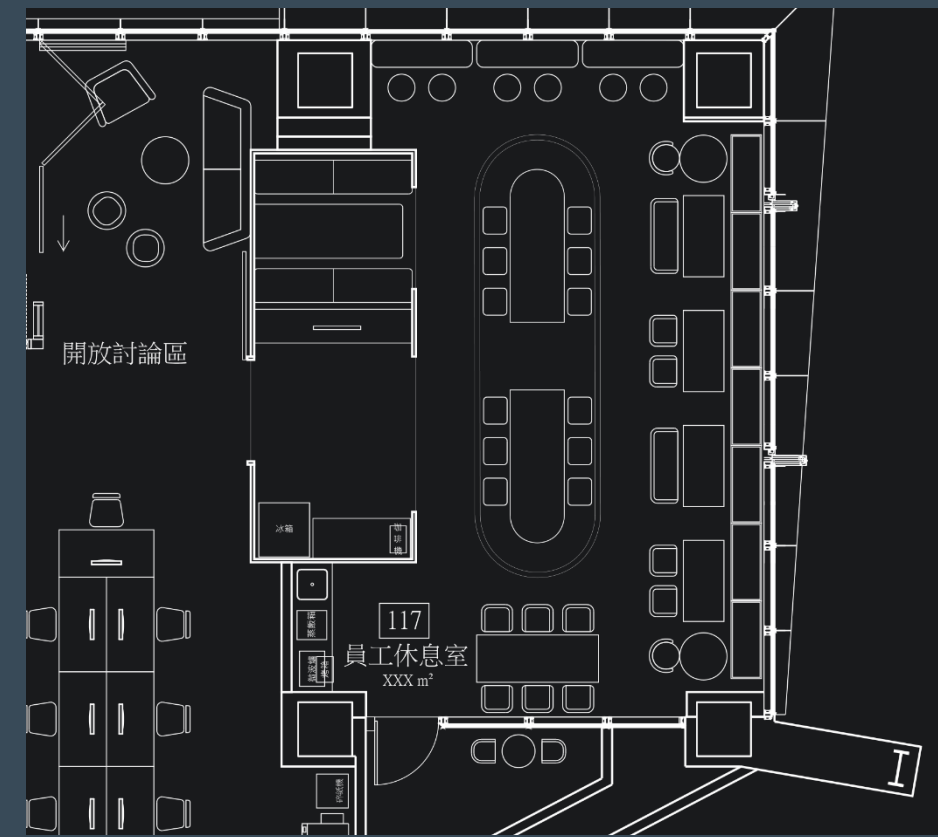

以貨櫃作辦公區與休憩空間的**中介過渡**，再將一些機能整合在其中
The cargo containers as an intermediary transition between office areas and Break room, with some functionalities integrated within.



Break Room

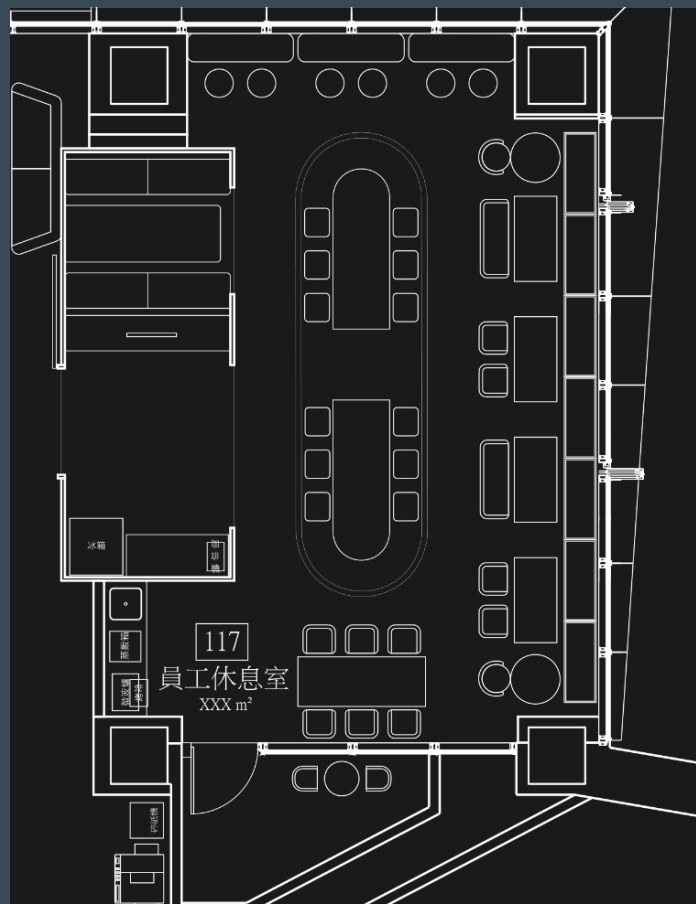

白色與木紋的空間基底，加上清爽的顏色家具，中央輕巧的高腳桌搭配有**植物意象**的棚架，強化綠色清新的感受，沿窗面設有類似船舷圓窗的鏡子，加強空間的進深感受。
The space features a color scheme of white and wood grain, complemented by lively colored furniture. High tables paired with plant shelves evoke a sense of a green forest.

Break Room

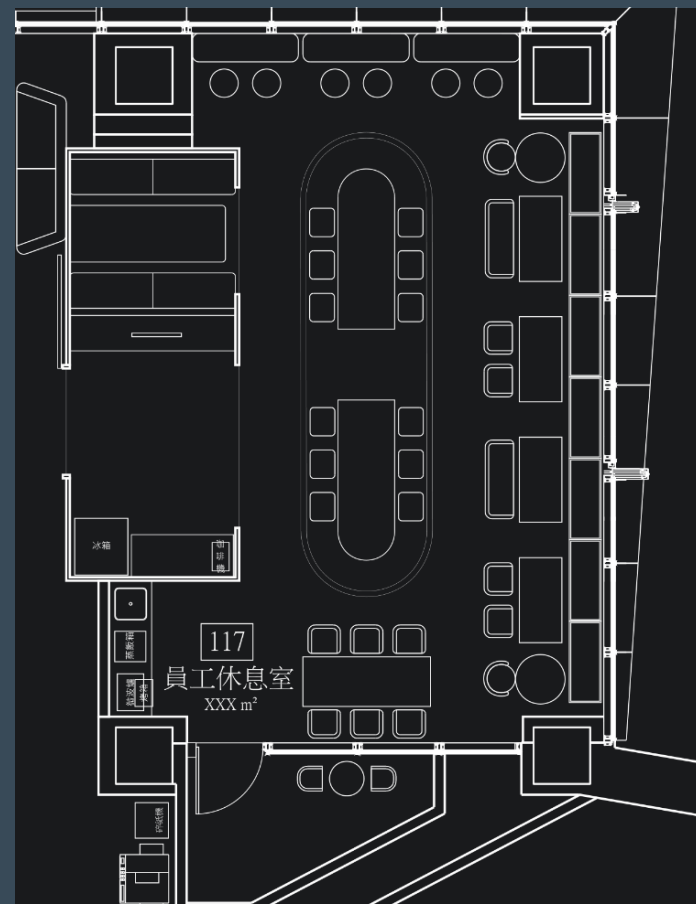

白色與木紋的空間基底，加上清爽的顏色家具，中央輕巧的高腳桌搭配有植物意象的棚架，強化綠色清新的感受，沿窗面設有類似船舷圓窗的鏡子，加強空間的進深感受。
The space features a color scheme of white and wood grain, complemented by lively colored furniture. High tables paired with plant shelves evoke a sense of a green forest.

Break Room

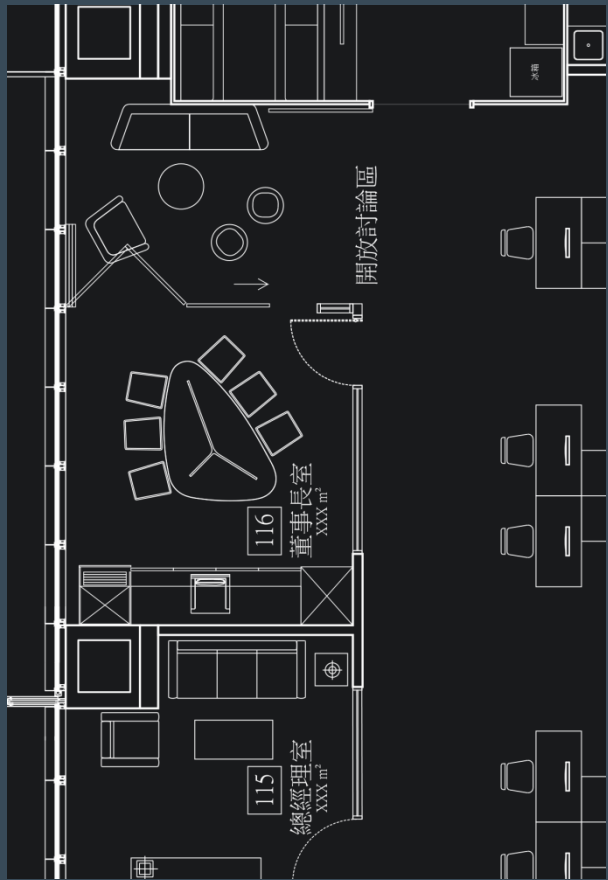

高階主管辦公室 / 部門主管辦公區的正面長向立面，木紋質感的頭柱，使用灰色調烤漆框+玻璃分割，視線高度設置與船舶相關工程圖圖像的霧面玻璃貼，做視線遮擋。

The frontal longitudinal facade of the executive offices/departmental management areas features wooden-textured pillars. Utilizing grey-tone baked paint frames with glass partitions, the line of sight is obscured by frosted glass panels depicting engineering diagrams related to ships, positioned at eye level.

Partition wall

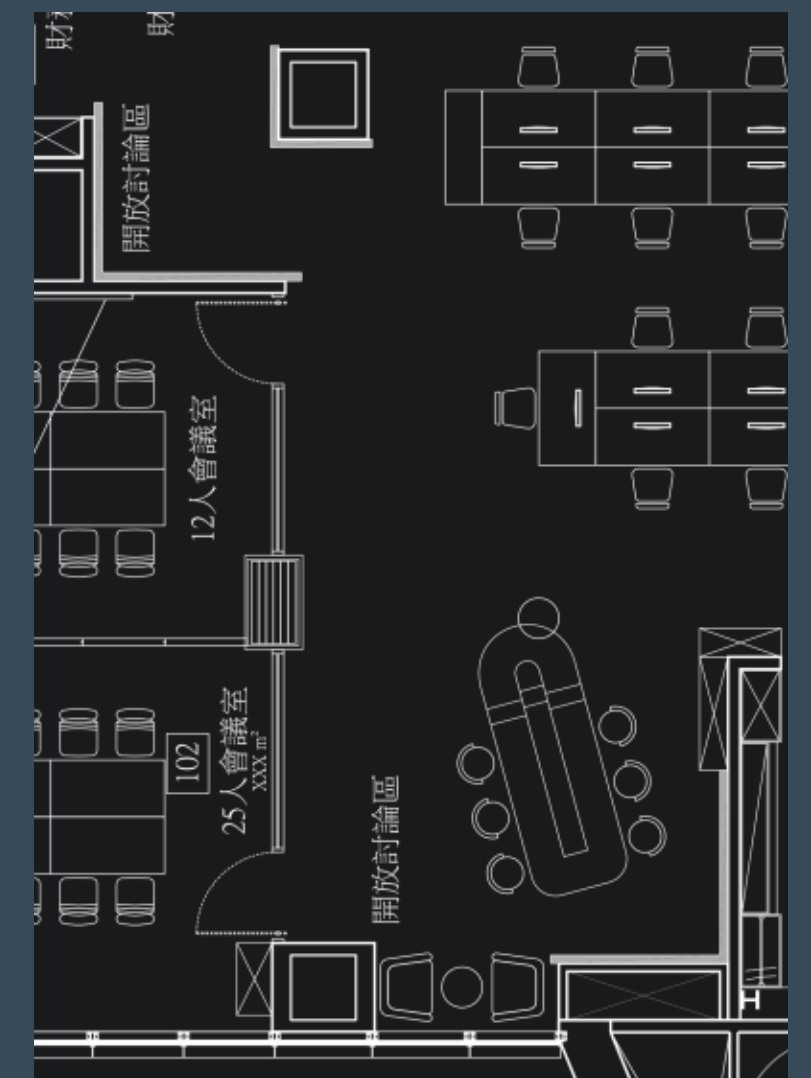

長軸空間的端點設置開放的**開放討論區**，是軸線的轉折點也是視線的端點，可供討論 / 留言 / 公告使用。

At the end of the office, there is an open discussion area available for discussions, leaving messages, and posting announcements.

Open Discussion Area

大會議區外設有休息/討論的前區，提供同仁討論 / 與會外賓休息或會議間的討論需求。討論牆面旁轉角設有開放圖書櫃供同仁使用。

Outside the conference room, there is a lounge area for colleagues to discuss and wait. Adjacent to the discussion wall, there is an open bookshelf situated at the corner for colleagues to browse and use.

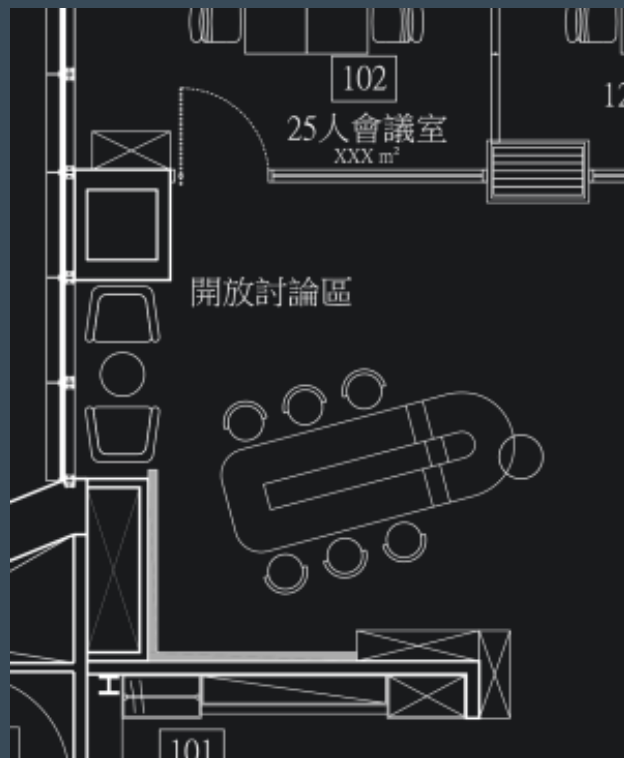

Open Discussion / Library

大會議區外設有休息/討論的前區，提供同仁討論 / 與會外賓休息或會議間的討論需求。討論牆面旁轉角設有開放圖書櫃供同仁使用。

Outside the conference room, there is a lounge area for colleagues to discuss and wait. Adjacent to the discussion wall, there is an open bookshelf situated at the corner for colleagues to browse and use.

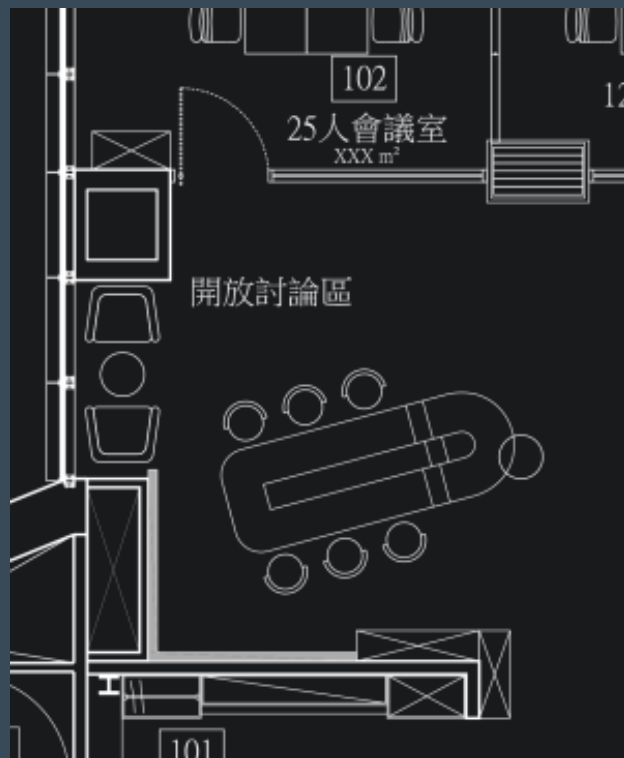

Open Discussion / Library



Open Office

開放辦公區底牆為事務及私人櫃的設置區域，兼設有事務機具 / 開放討論區的機能場域。

The wall in this area serves as the setup area for office and personal cabinets, while also accommodating office equipment and functioning as an open discussion area.

辦公室次入口設置緩衝的討論區，並且提供開放空間的使用機能。

The second entrance of the office is equipped with a discussion area, providing functionalities for the communal use of employees.

Open Discussion





大會議室活動隔屏可使用關閉/開啟二種模式。活動隔屏表面面貼磁性白板，可供會議書寫使用。窗邊設置會議螢幕，整間模式時可使用投影布幕。

The activity partition in the main conference room can be used in two modes: closed and open. The surface of the activity partition is a magnetic whiteboard, suitable for writing during meetings.

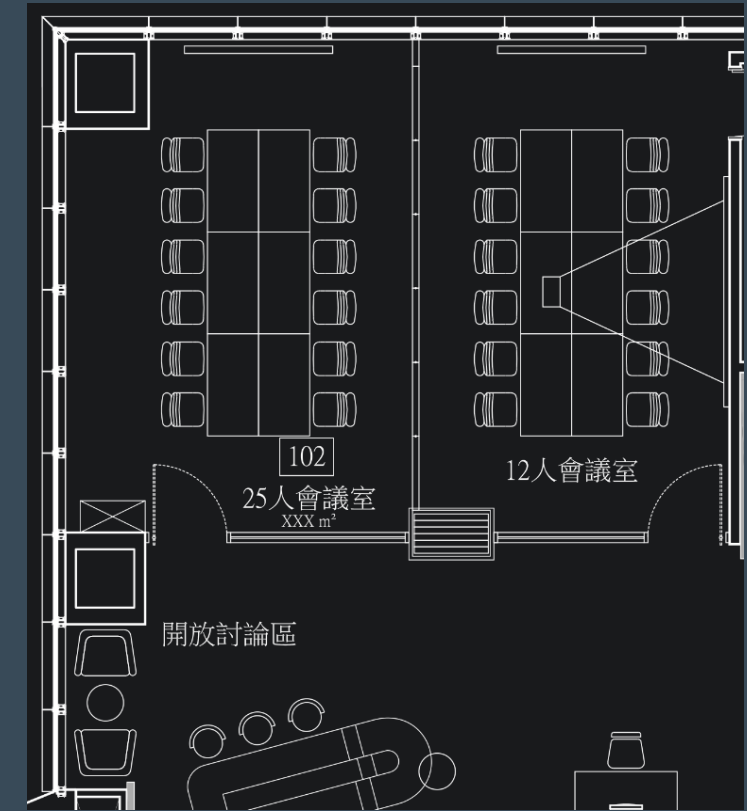

Conference Room





大會議室活動隔屏可使用關閉/開啟二種模式。活動隔屏表面面貼磁性白板，可供會議書寫使用。窗邊設置會議螢幕，整間模式時可使用投影布幕。

The activity partition in the main conference room can be used in two modes: closed and open. The surface of the activity partition is a magnetic whiteboard, suitable for writing during meetings.

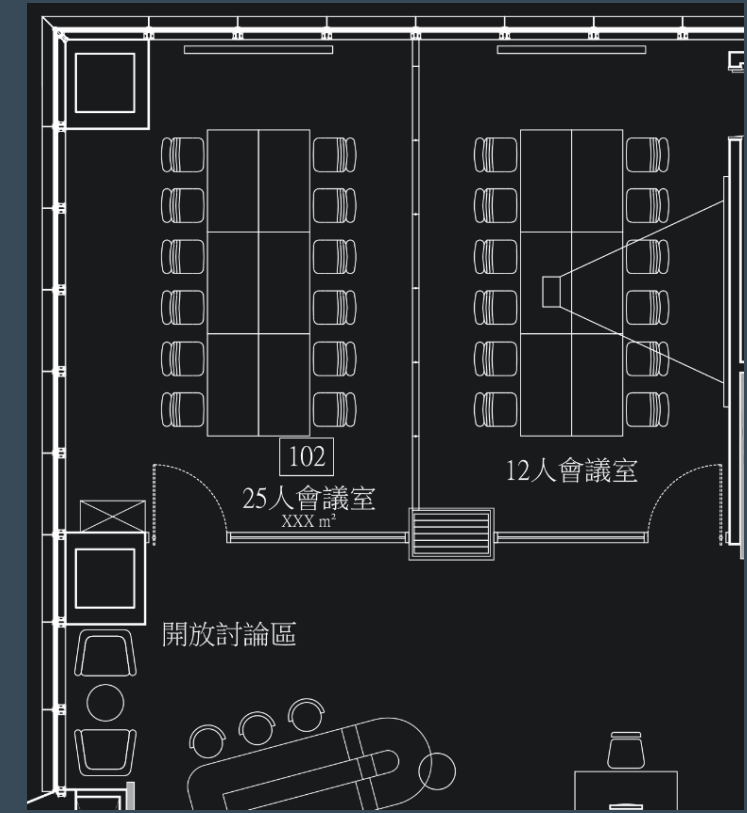

Conference Room

**THANK YOU FOR
WATCHING!**