



華人之創獎

TAIWAN GOOD DESIGN AWARD

微視野

Well Vision

作品資訊

Work information

項目地點：台灣中部

項目類型：工作空間類

項目規模：155.37平方米

主要建材：木作、實木皮、噴漆、鐵件、玻璃、
黑鏡、系統板、木百葉、壁紙、波隆地毯

Site location: middle of Taiwan

Type of construction: Working space

Construction of size: 155.37 square meters

Main building materials: Wood, Solid wood,
Spray paint, Iron, Glass, Black mirror, System
board, Wood shutters, Wallpaper, Bolong carpet

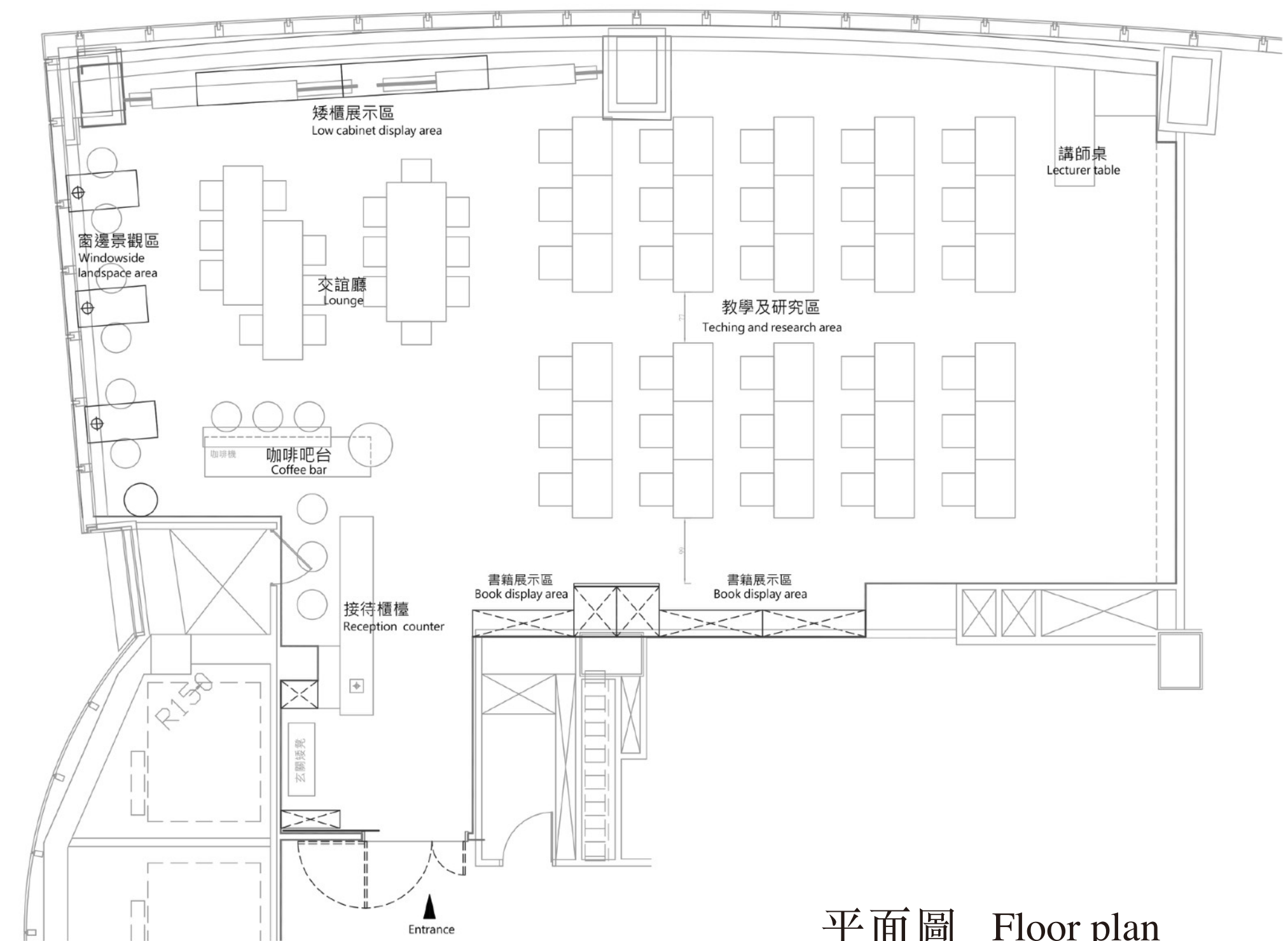

平面圖 Floor plan



項目定位

Design Proposition



本案為國際性的顯微教育中心，使用者以專業醫學從業人員為主，涵括來自世界各國之專家學者，為因應其國際性質，與之結合The Landis Taichung Hotel ONE樓棟外觀元素，發展出以斜線量體交織圓型鐵件框構的大氣視野。

而其靈感來自英國的倫敦眼，作為城市的地標，能夠於此搭乘觀景輪登高望遠，一覽城市天際線；於是我們將這樣的概念置入天花板中，向外延展至窗外的大片光景，向下延伸至牆面、櫃體的線條交織意象，藉此象徵場域宗旨為透過研討交流，吸收彼此專業學識，從而延續、擴散，達至融匯、圓滿的合作結果。

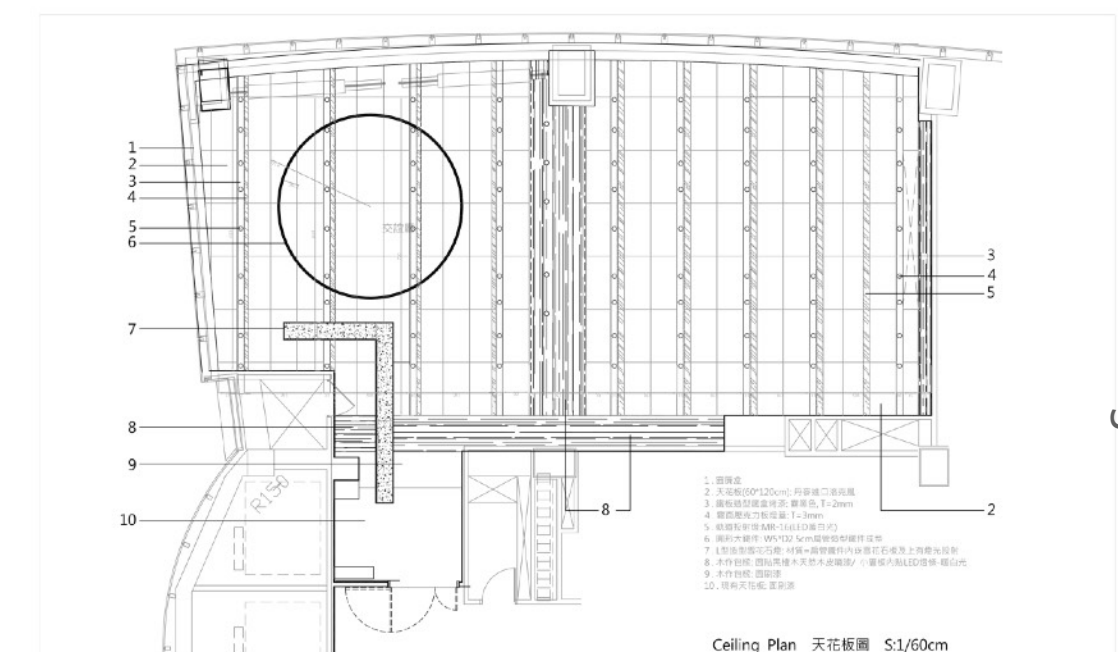

Ceiling Elevation



風格情境

Creativity & Aesthetics



因場域屬研究性質，且時常匯聚國外專家學者，我們便利用黑色鐵件調性及白色斜支撐鋼樑結構，於寬闊場域下建構國際化氛圍，空間中盡是散發沈穩大氣之感。乍看之下，形體亦如顯微鏡外觀，虛實相結合，亦透過西向的地理位置，嵌入光影變化，使整體空間更具生命力。

The experts and scholars at home and abroad are often gathering here for research. The designer hopes to make use of the potent tone of black steel piece and the bright white diagonally braced steel beam structure, to bring about an international circumstance in this capacious space, moreover imbue a sense of composed ambience. At first glance just like the appearance of a microscope, as if combines of virtual and reality.

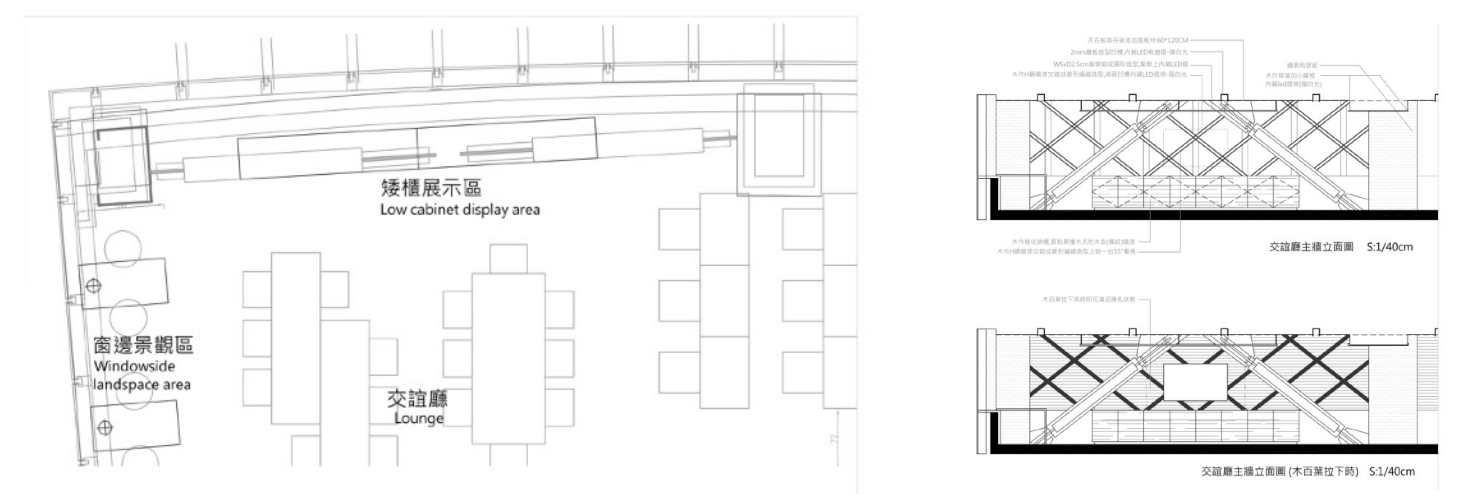

Main Wall Elevation



空間配置

Space Planning



為讓47坪的場域能容納較多的學術人員，並提供寬敞的活動範圍，我們以開放式設計為主軸，將空間劃分為交誼區及研究區兩大區塊。進門的交誼區為複合式性質，研究人員能在此做技術交流，亦能到吧台放空思緒稍作休憩，因此這處的天花板以優雅溫潤的雪花石為分界，搭配略帶變化的L型櫃檯設計，為空間創造視覺意趣。

Taking the open design as the main scheme, divided the space into two parts: the recreation area and the research zone. Make the 155 square meters space can accommodate the academic staff as many as well and provide a vast realm for activities. The recreation area is a composite space. Researchers can exchange know-how here and relax at the bar. For the purpose, the ceiling is build of elegant alabaster; collocate with the L-shaped counter, thus creating a delightful vision for the space.

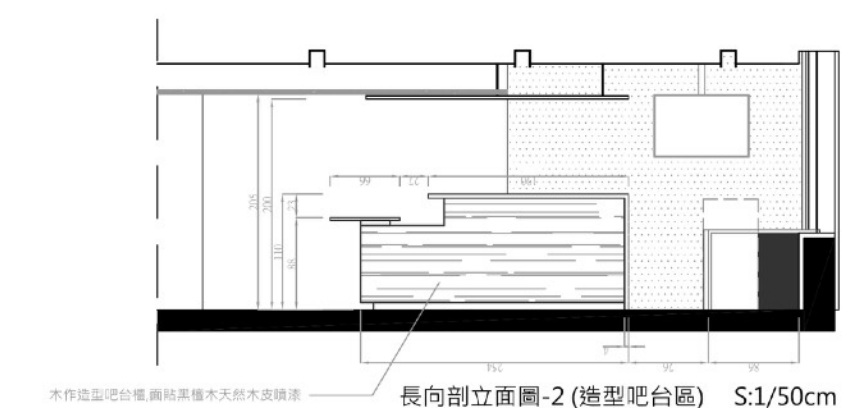

Styling bar
Elevation

木作造型吧台櫃、圓形桌檯木天板木皮牆漆 長向剖立面圖-2 (造型吧台區) S:1/50cm



空間配置

Space Planning



而向內走去則是矩形劃設的研究區域，避開人員的走動出入，於此能專心於技術研究，場域後方的木百葉窗設計，也讓空間同時具有穿透感及隱私性，可靜可動的格局動線規劃，為中心帶來更多彈性效用。另外在機器設備的線路規劃部分，考量使用上的便利性和安全性，我們事先在鋪設地毯前，便將所有線路隱藏於溝槽內，進而達到整齊收束的視覺效果。

Step inward is the modular research zone. Seldom people walk in and out, thence can concentrate on professional investigation. The wooden shutters in the rear bring either penetrating and privacy perception for the space. Arrange the static and movable flow planning that brings much more flexible usage of the center. Contemplate the convenience and safety of the circuit usage of the electric equipment, the designer carefully plan to hide all the circuits in the slot before laying the carpet, and then achive the visual effect of neat and tidy.

選材效用

Materials & Cost Effectiveness



重點

1

選用瑞典BOLON地毯，其抗磨、耐燃、易清潔的優良性能，使研究操作上更安全無虞。



重點

2

大片純白天花板為綠建材——丹麥ROCKFON，其具有防潮、隔音、防火之實用性能。

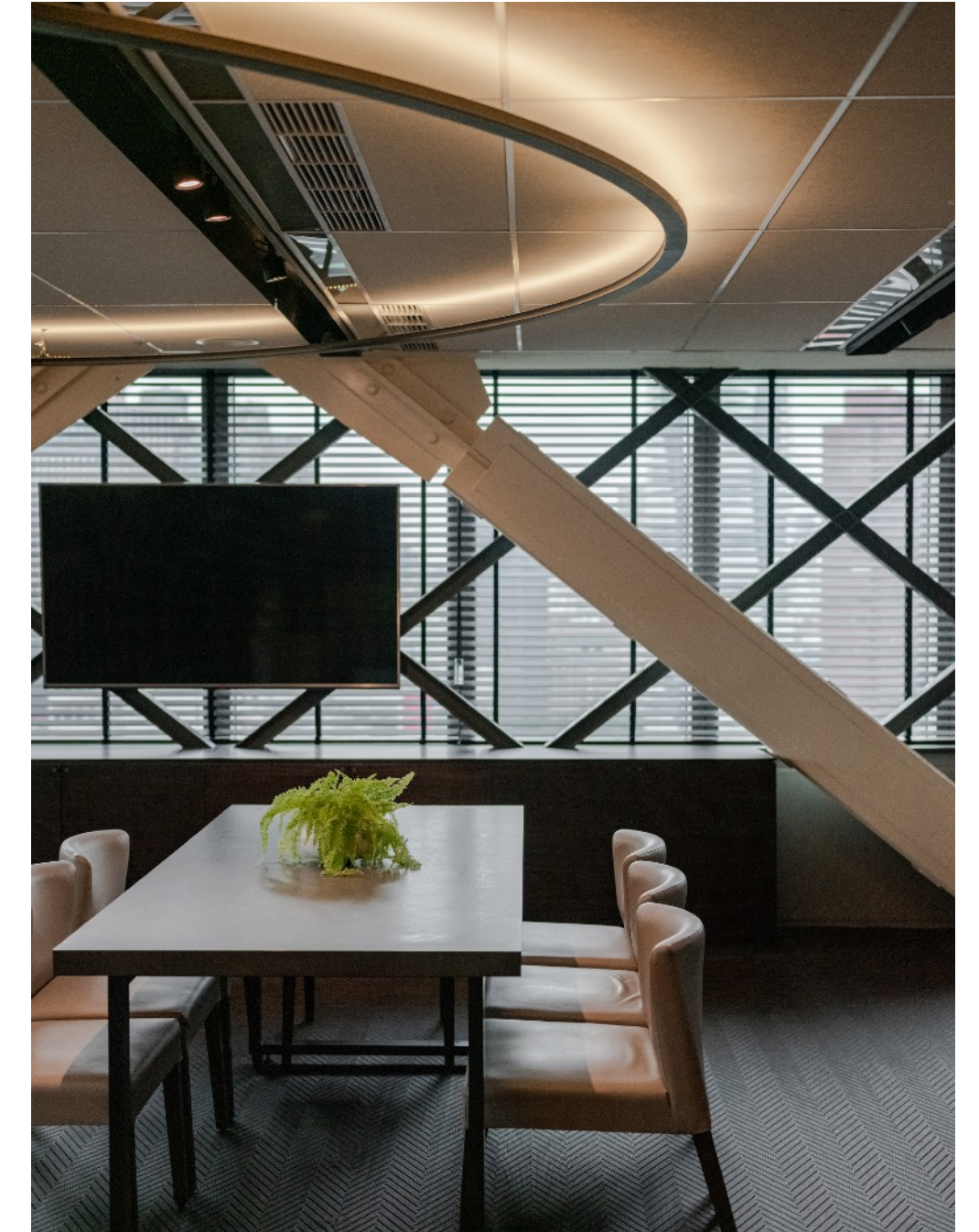

重點

3

我們搭配全熱交換器，以此增加室內空氣含氧量，達到淨化空氣品質、能源回收、節能省電之效。

櫃檯區

counter

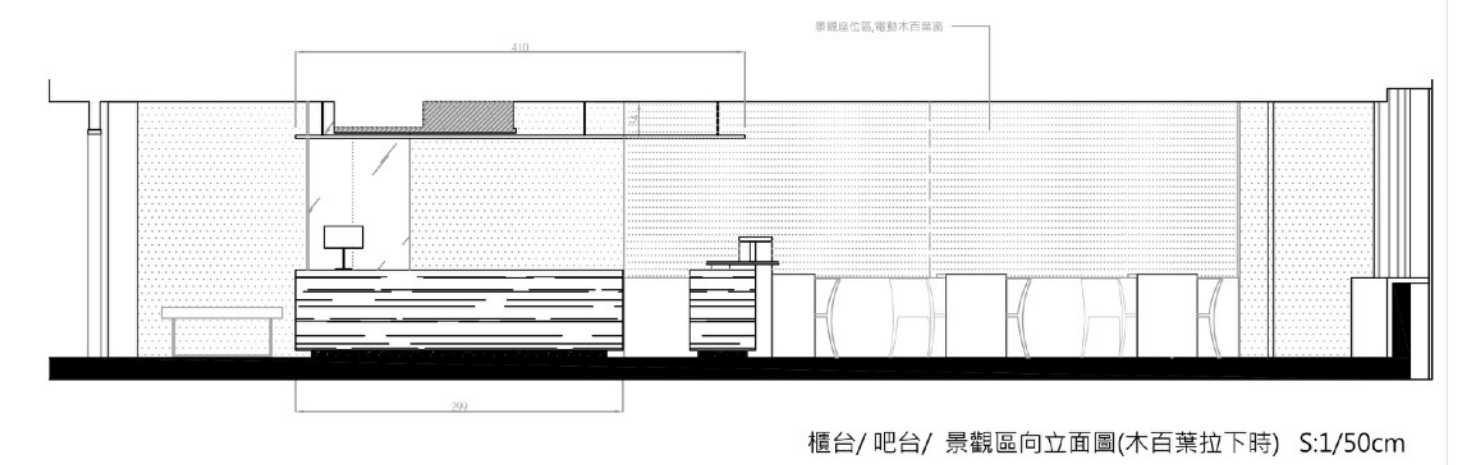
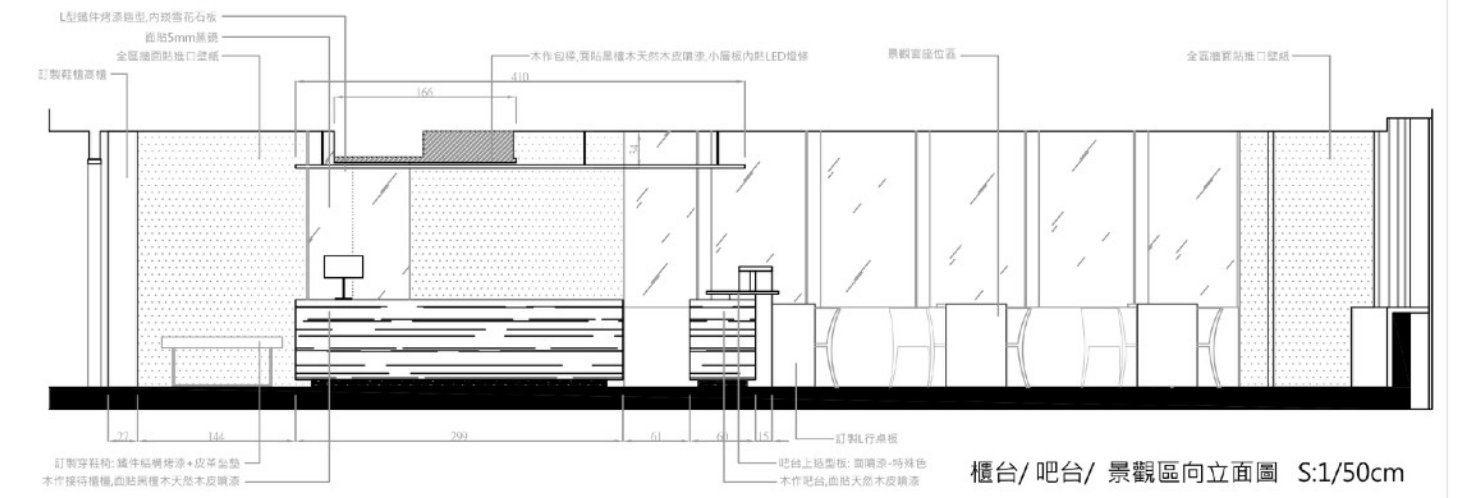
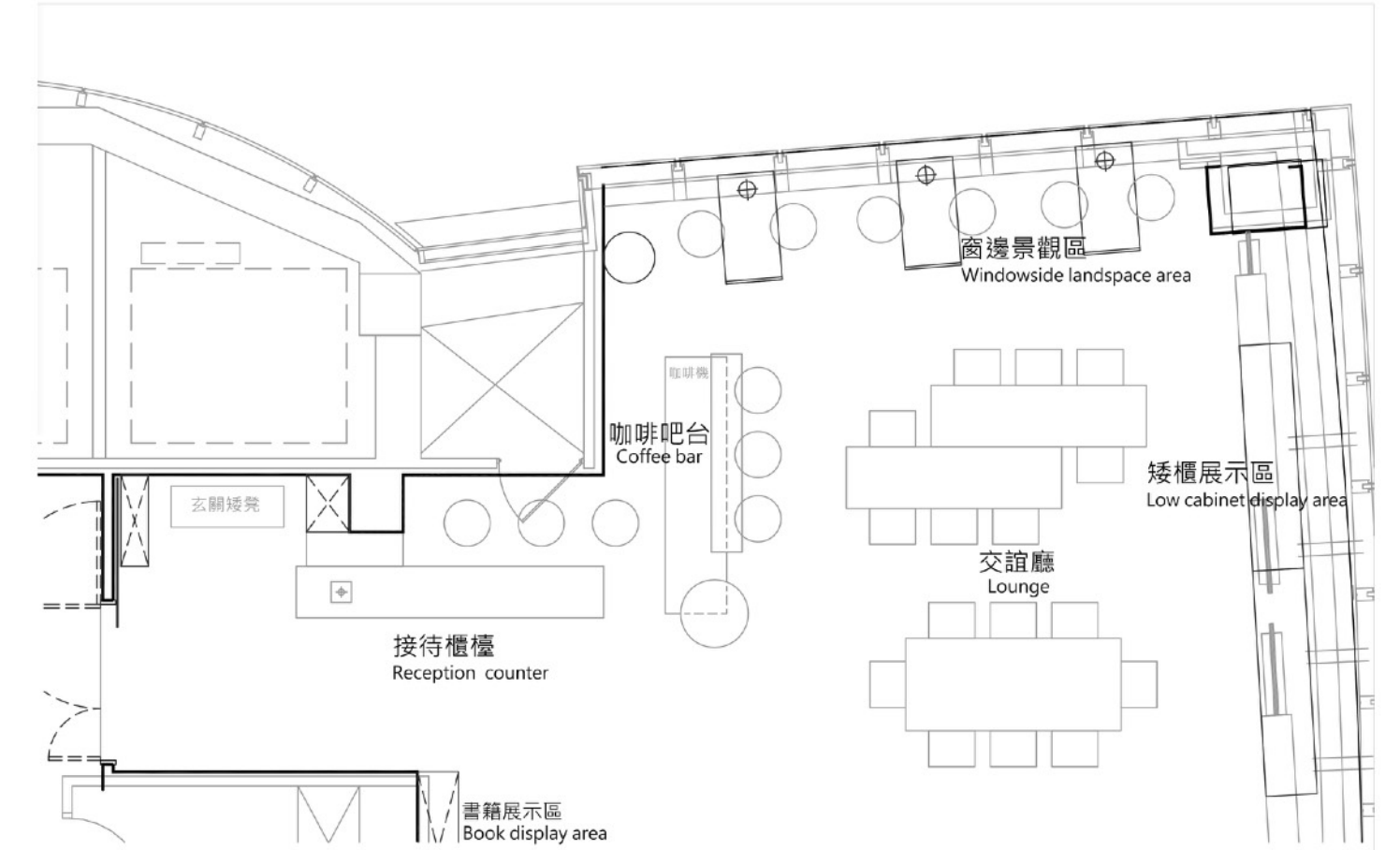

造型書櫃

Styling Bookshelves

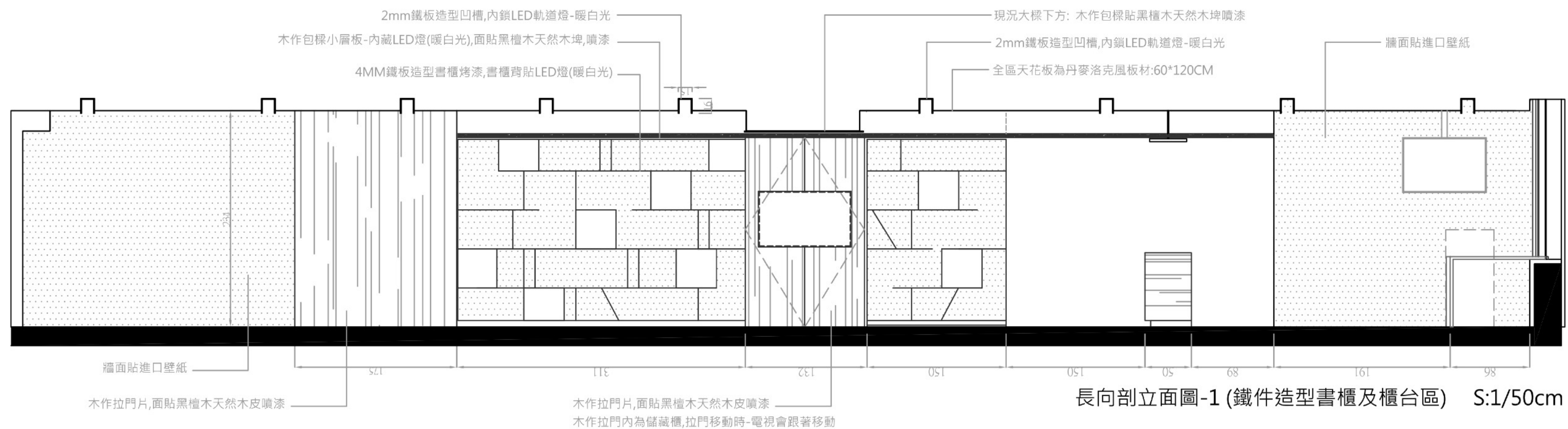
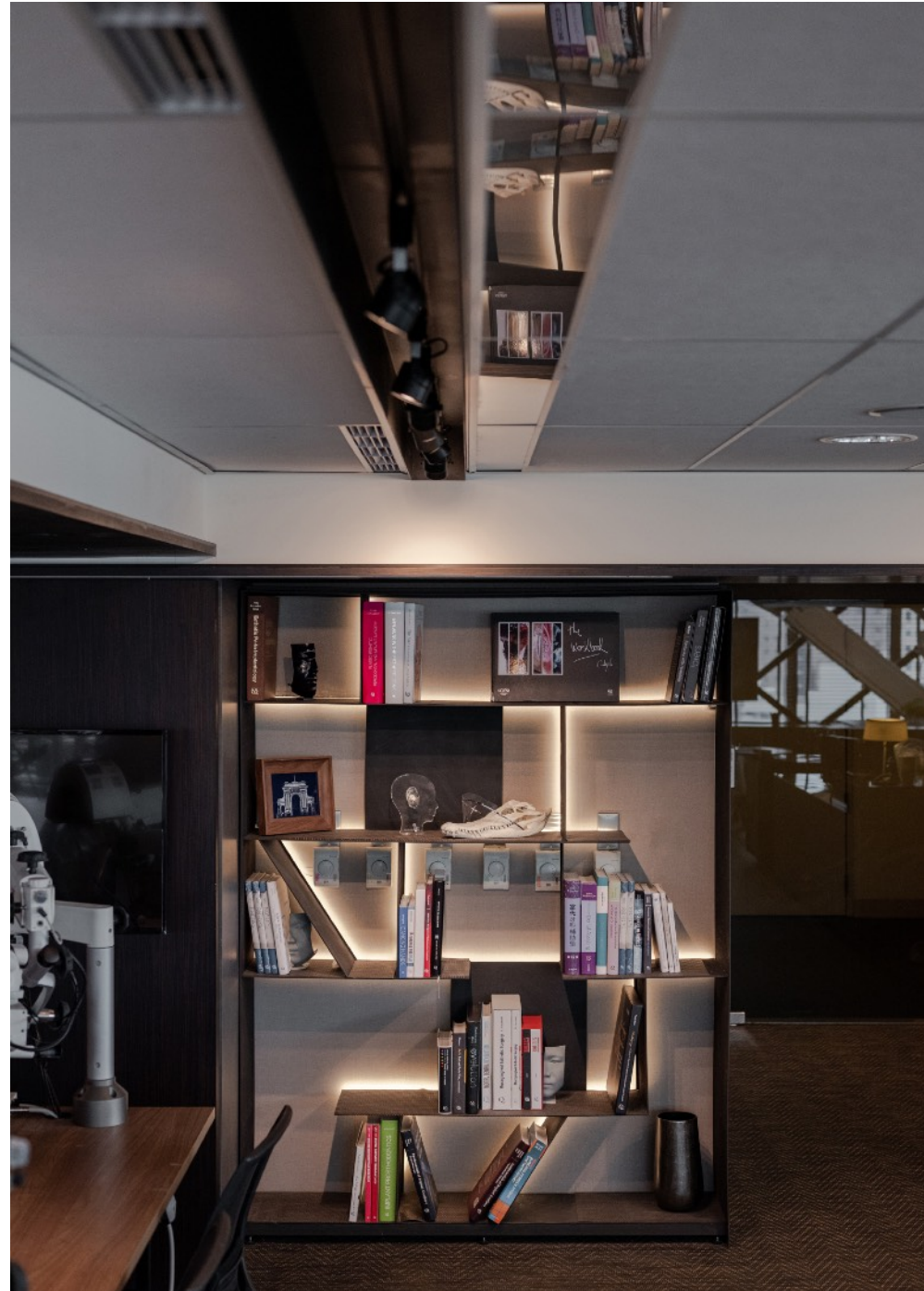



華人之創獎

TAIWAN GOOD DESIGN AWARD

THANK YOU