

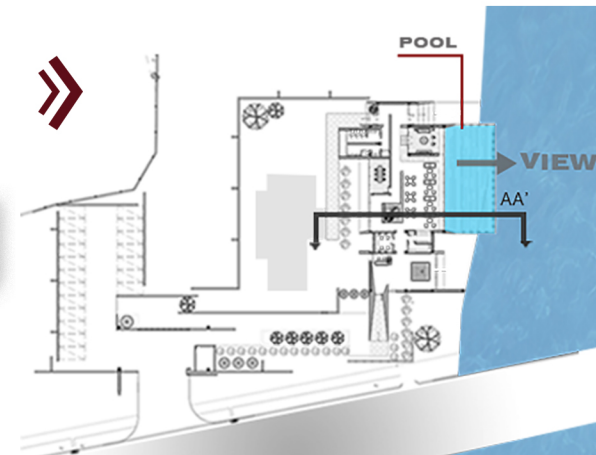

PENETRATION

PENETRATION

CONCEPT

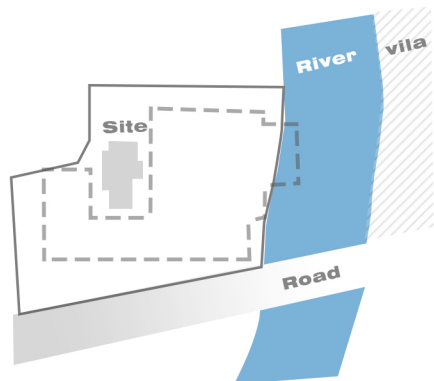

The project locates at the crossing of Changqing Road and Yongyi Road with a river in the front. We undertake the architecture, interior, landscape, finish and furnishing design of the project which shorten the distance between natural environment (river) and human. We establish waterscape in the interior space of the building and bring the river view into interior space.

BLOCK NOISE

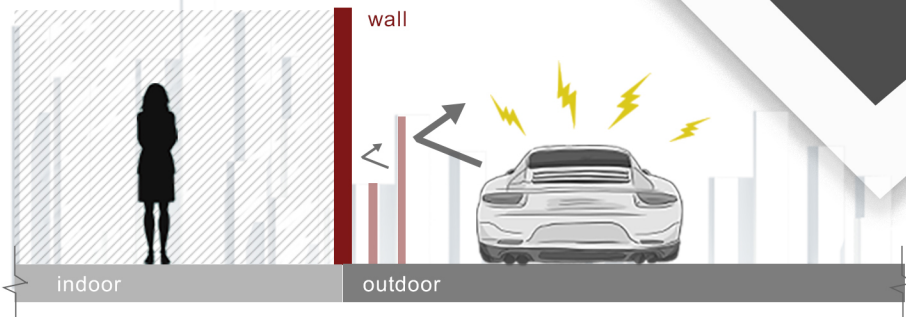

SPACE DIVISION

Interior and exterior landscape is used to enhance the natural scene of the project. On the road side, high solid wall is built as the partition in vision and noise. This guides and switches vision of the guest to the landscape direction aiming at to avoiding the disadvantage of noisy road.



There is riverside in front of the project and a municipal road on the side. Based on special condition of the project, the designer conduct space division and set an architectural wall: on the side facing the river, large area of glass curtain wall is made to open the view to natural landscape, while on the side facing the road is divided with solid wall to avoid noise.

SECTIONAL VIEW AA'

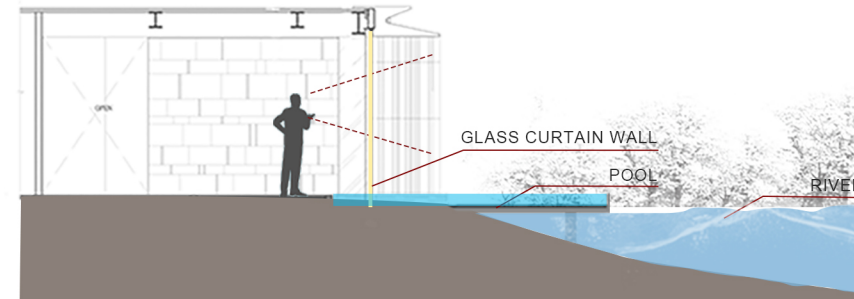



We designed water scape on the side facing the river to shorten the distance between the river and the building and introduce the water scape into the interior space. This design brings the natural water scape to the people and make people and the nature closer.







Environmental friendly material is applied in all the spaces of the building. Steel structure is used for architectural structure and frameless glass curtain wall is designed to connect the exterior and the interior space. Façade of the building is applied with calcium silicate board which is a kind of cost-efficient material and can be installed easily with compliance to relevant water-proof and fire-proof codes.











